

Rozino Nano Linear Wall Grazer

Specification Submittal

Rozino is one of the most powerful wall grazers in its class with a peak candela of 4700+ and a precise 10° beam angle. It is designed to highlight architectural surface details with unparalleled clarity. Rozino includes a patent-pending paintable fixture cover that can bridge up to 150 feet of individual fixtures to create a continuous monolithic fixture look without unsightly seams, or mounts showing. Painting the pre-primed fixture cover to color-match the ceiling will allow the fixture to blend in with its surroundings. Perfect for both commercial and sophisticated residential settings, Rozino combines aesthetic flexibility with cutting-edge technology to enhance any space.

Project Name:

Project Location:

Fixture Type:

SKUs:

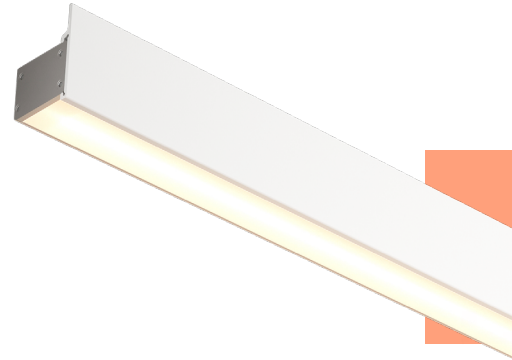

Features & Benefits

- Designed with a precise 10° beam angle, Rozino effectively highlights architectural details
- Powerful 4700+ peak center beam candela made possible by an advanced multi-element optical system
- Continuous fixture lengths up to 8 ft.
- Continuous, paintable fixture cover for spanning multiple fixtures up to 150 feet
- Pivoting and lockable mounting hardware allow the fixture to be mounted at the best angle for maximum effect
- Canopy kit options available
- Complete UL listed luminaire

Dimensions

Fixture Cross Section

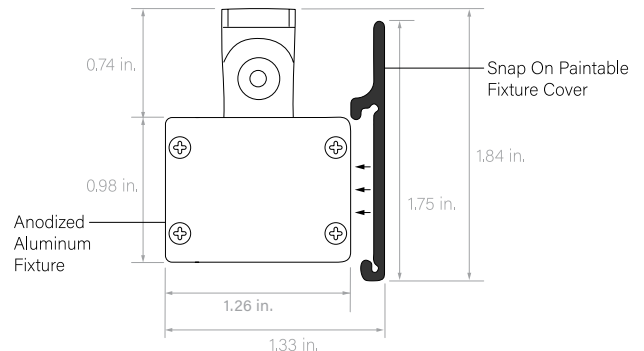

System Builder choose one option for each step.

Prefix	Location	Output	CCT	Lens	Canopy Kit	Finish	Length	Lead	Lead Length
OP-SFU-ROZ-	O	L4		10D		ALU		1LEAD	
	O Outdoor	L4 2700K - 447 lm/ft (6W) 3000K - 457 lm/ft (6W) 3500K - 479 lm/ft (6W) 4000K - 494 lm/ft (6W)	2700K 3000K 3500K 4000K		250 2.5 in. Diameter canopy For mounting directly to the wall. (No junction box) 500 5 in. Diameter canopy For mounting with the use of a junction box.		XXX Length in 1 in. increments - The fixtures come in segments up to 96 in. - Fixtures up to 96 in. will be assembled at the factory - If over 96 in., multiple segments of the profile will be supplied.	1LEAD One lead - By default leads come out the end of the fixture. If the lead length is followed by the letter "T" it means the lead will come out the TOP of the fixture 	XXX 1-120 in.

Fixtures are supplied with Optique's remote Universal power supply supporting 0-10, 1-10V, MLV, ELV dimming and voltage input from 100V-277V.

Rozino Nano Linear Wall Grazer

Specification Submittal



Photometry

Rozino Nano Linear Wall Grazer

LUMEN SUMMARY

Zone	Lumens	% Fixture
0° - 15°	217 lm	47.48%
0° - 30°	320 lm	70.02%
0° - 45°	394 lm	86.21%
0° - 60°	433 lm	94.75%
0° - 75°	449 lm	98.25%
0° - 90°	454 lm	99.34%

ANGULAR DISTRIBUTION 0 - 90°

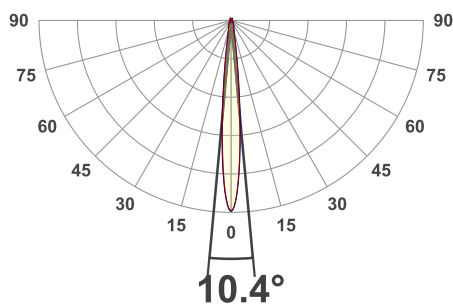

BEAM ANGLE

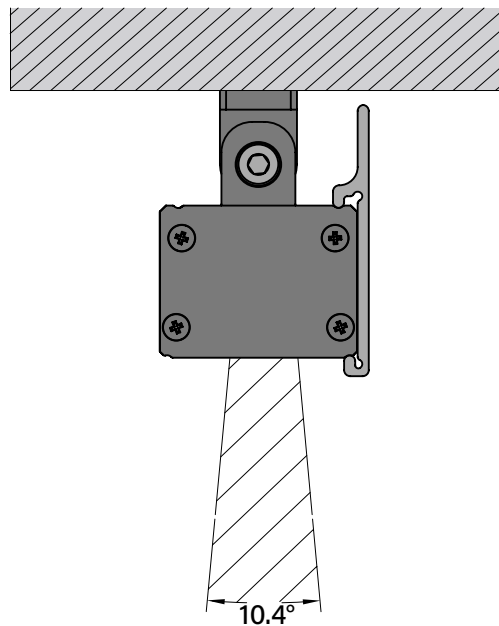

COLOR VECTOR GRAPHIC

Hue Bin	R_f	Graphic shifts (%)	
		Chroma	Hue
1	93	-3%	1%
2	96	-2%	1%
3	96	-1%	1%
4	94	-4%	-2%
5	96	-3%	1%
6	97	-1%	1%
7	93	-4%	2%
8	96	0%	2%
9	93	-1%	4%
10	91	1%	6%
11	92	3%	6%
12	92	4%	-1%
13	93	1%	-6%
14	90	2%	-7%
15	93	-3%	-1%
16	88	-2%	-9%

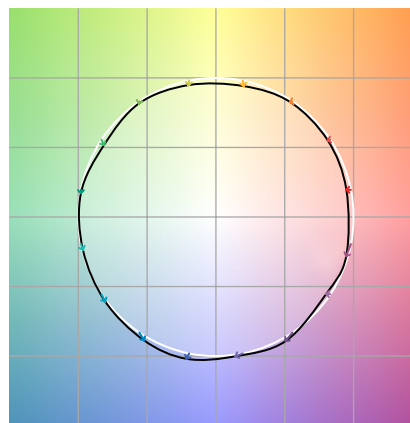

Rozino Nano Linear Wall Grazer

Specification Submittal

Photometry

FOOT CANDLES
3000K Rozino Nano Linear Wall Grazer

Distance	Foot Candles
1'	4766 fcd
1.5'	2118 fcd
2'	1191 fcd
2.5'	763 fcd
3'	530 fcd
4'	298 fcd
5'	191 fcd
6'	132 fcd
9'	59 fcd
12'	33 fcd

DISTRIBUTION OF FOOT CANDLES
8 ft., 3000K Rozino Nano Linear Wall Grazer

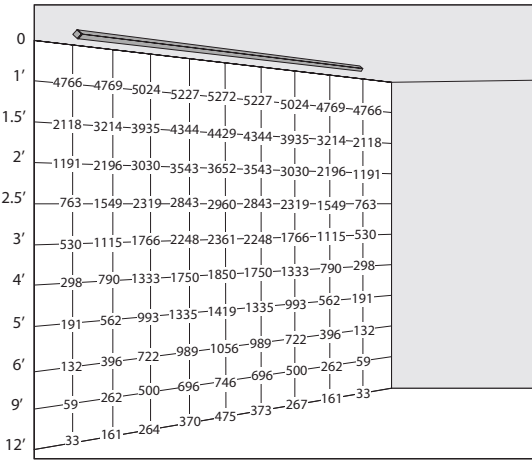

LIGHT DISTRIBUTION

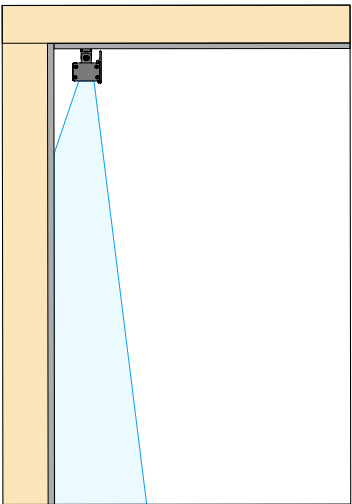

Side view

LIGHT DISTRIBUTION

8 ft., 3000K Rozino Nano Linear Wall Grazer

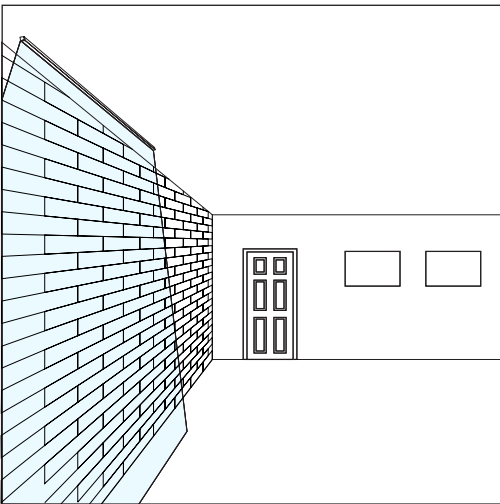

Isometric view