

# Orbita Wall Mount Nano Linear Fixture

## Specification Submittal

Our sleek, versatile Orbita Wall Mount features field-adjustable, indirect light distribution and is offered in four segmented lengths and multiple configurations. Add versatility and style to your home lighting or commercial lighting solutions by lighting spaces, highlighting items, and more.



### Features & Benefits

- Available in multiple lengths and up to three segments
- 360° light rotation to effortlessly fine-tune the direction of the light
- Superior color rendering
- High R9 and R13 values
- 2-step MacAdam ellipse for unparalleled quality and consistency
- UL Listed and Title 24

Project Name:

Project Location:

Fixture Type:

SKUs:

### Dimensions

See next page for more details.



NOTE: Shown using 12 in. light engines

### System Builder Choose one option for each step.

Prefix	Configuration	Output	CCT	Canopy	Finish	Length
OP-SFU-ORBITA-		L3				
	<b>SURF1</b> Surface mount fixture made up of one segment. 	<b>L3</b> 2700K - 201 lm/ft (4W) 3000K - 210 lm/ft (4W) 3500K - 225 lm/ft (4W) 4200K - 236 lm/ft (4W)	<b>2700K</b> <b>3000K</b> <b>3500K</b> <b>4200K</b>	<b>275</b> 2.75 in. Diameter canopy For mounting directly to the wall (No junction box)  <b>500</b> 5 in. Diameter canopy For mounting with the use of a junction box  <b>500D</b> 5 in. Diameter canopy For mounting with an included Driver that fits most 4-inch junction box.	 <b>STB</b> Satin Brass   <b>MBL</b> Powder Coated Matte Black RAL 9005	<b>12</b> 12.56 in. light engine Lumen output: 263 per segment  <b>18</b> 18.32 in. light engine Lumen output: 394 per segment  <b>24</b> 24.08 in. light engine Lumen output: 525 per segment  <b>36</b> 35.61 in. light engine Lumen output: 788 per segment  – Total length is limited to 10 ft. (120 in.)  – If fixture has more than one section, it will use the chosen length for each section

# Orbita Wall Mount Nano Linear Fixture

## Specification Submittal

### Dimensions

#### 12 in. Light Engine

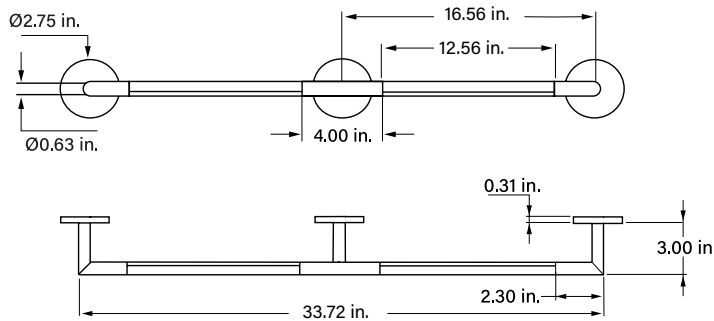

#### 18 in. Light Engine

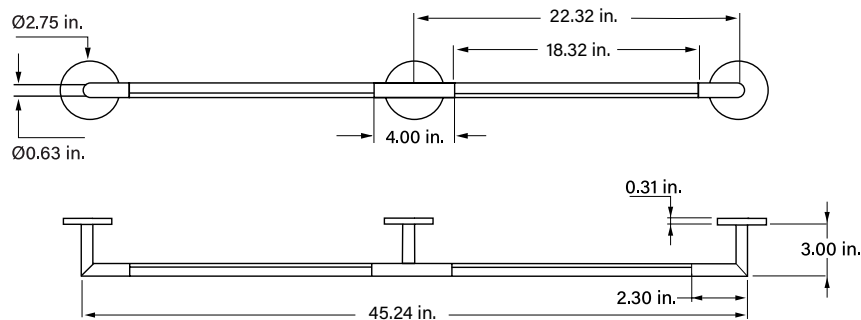

#### 24 in. Light Engine

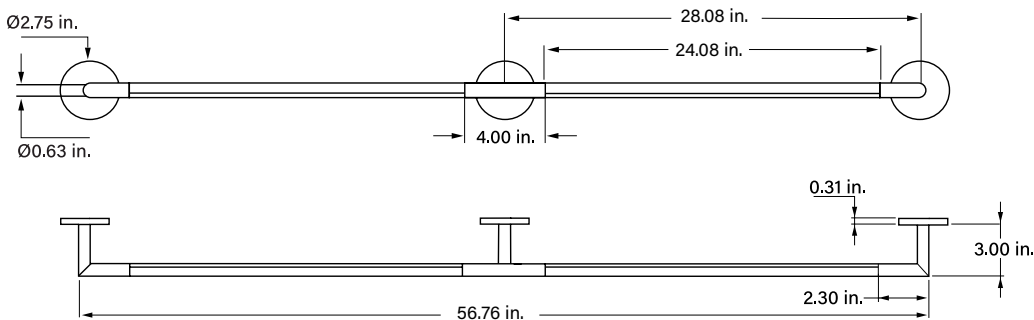

# Orbita Wall Mount Nano Linear Fixture

## Specification Submittal

### ✂ Dimensions

36 in. Light Engine

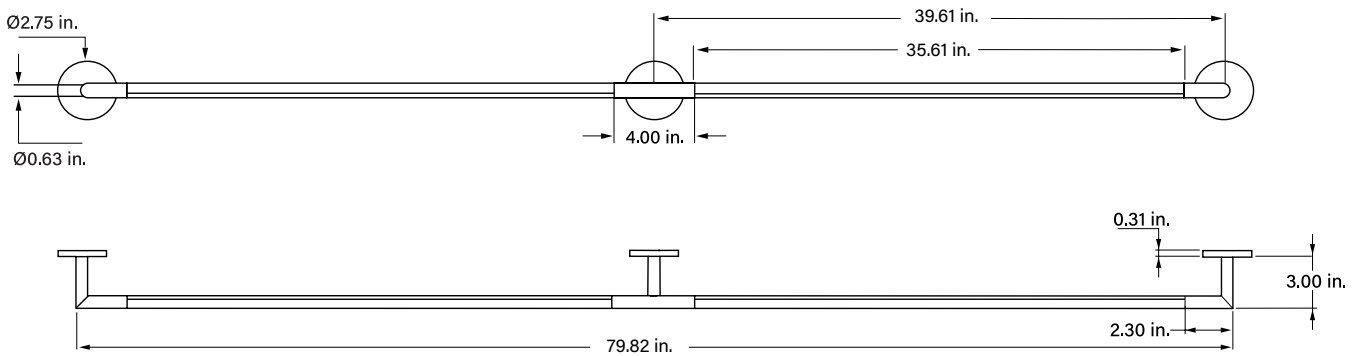

### Light Engines

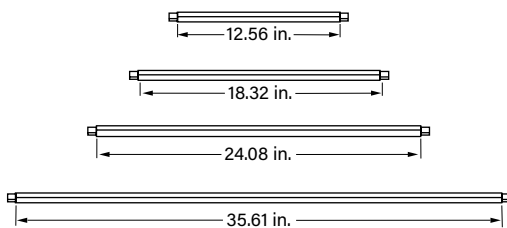

### Canopy

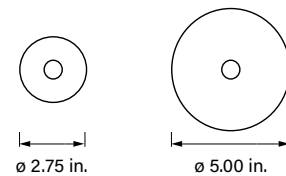

NOTE:  $\varnothing$  = diameter

# Orbita Wall Mount Nano Linear Fixture

## Specification Submittal

### Power Supply

#### Features

- Input Voltage: 90-130VAC / 180-240VAC
- High Efficiency: up to 89% ; PF>0.95
- Suitable for dry or damp location use.
- Compatible with 0-10V and 1-10V Dimmers.

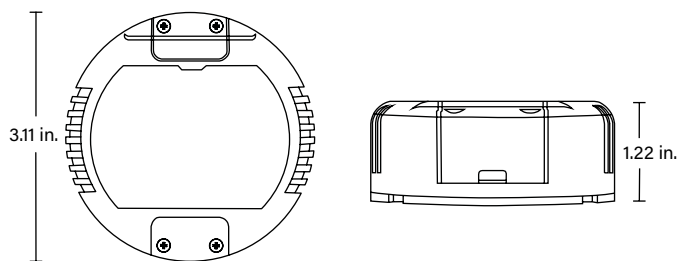

#### Diagram Connection

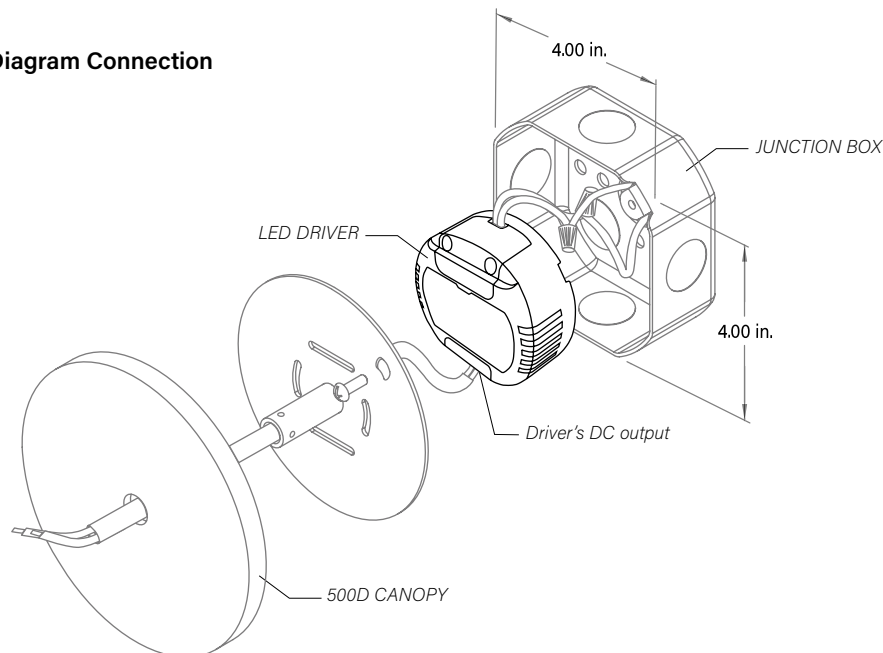

\*Note: If Canopy 275 or 500 is selected, Optique Lighting will specify a universal remote driver that supports 120-277.

# Orbita Wall Mount Nano Linear Fixture

## Specification Submittal

### ✦ Photometry

1 ft., 3000K Orbita Nano Linear Fixture

#### LUMEN SUMMARY

Zone	Lumens	% Fixture
0° – 15°	9.13 lm	4.35%
0° – 30°	34.6 lm	16.48%
0° - 45°	70.7 lm	33.67%
0° - 60°	110 lm	52.38%
0° - 75°	147 lm	70.00%
0° - 90°	175 lm	83.33%

#### FOOT CANDLES

Distance	Foot Candles
1'	43 fcd
1.5'	19 fcd
2'	11 fcd
2.5'	7 fcd
3'	5 fcd
4'	3 fcd
5'	2 fcd
6'	1 fcd
9'	1 fcd
12'	0 fcd

#### COLOR VECTOR GRAPHIC

		Graphic shifts (%)	
Hue Bin	R <sub>f</sub>	Chroma	Hue
1	96	1%	-2%
2	98	1%	0%
3	95	1%	2%
4	95	2%	2%
5	95	4%	2%
6	92	6%	1%
7	92	5%	-3%
8	92	4%	-3%
9	94	2%	-3%
10	95	0%	-3%
11	96	0%	1%
12	94	3%	1%
13	96	3%	0%
14	94	5%	-2%
15	95	2%	-2%
16	92	3%	-6%

#### ANGULAR DISTRIBUTION 0 – 90°

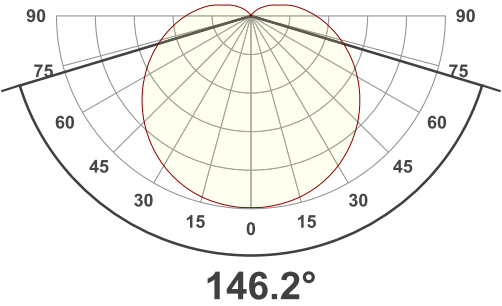

#### BEAM ANGLE

