

Millwork - Recessed - 90° Mounting Angle

Specification Submittal

Millwork - Recessed - 90° Mounting Angle is designed for woodwork and millwork applications and provides a refined, recessed luminaire tailored for shelves, desks, and counters. Designed to fit precisely into 1/4 in. wide by 3/8 in. deep milled slots in hardwood, plywood, and MDF. Its angled back ensures effortless installation, while the retention ridges inside the profile firmly secure the light engine in place, delivering a polished and professional result that fills the milled slot perfectly.



Project Name:

Project Location:

Fixture Type:

SKUs:

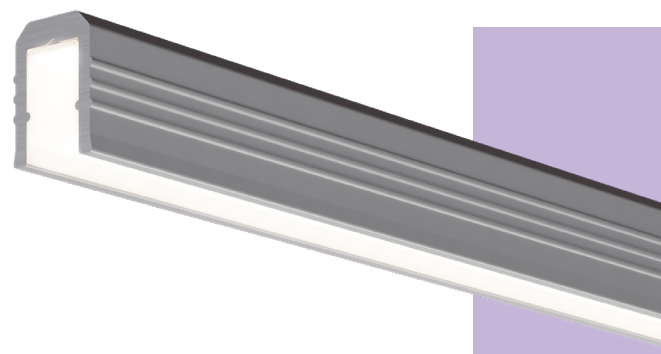

i System Builder for Fixture

Prefix	Location	Output	CCT	Finish	Mounting	Length	Lead	Lead Length
OP-REC-MW90	I	L1	<div>White Light</div> <div>2700K</div> <div>3000K</div> <div>3500K</div> <div>4000K</div>	ALU	NM	<div>XXX</div> <div>Length in 1 in. increments</div>	<div>1LEAD</div> <div>By default leads come out the end of the fixture.</div> <div>Finished fixtures are equipped with a factory pre-wired end piece, with the lead exiting from the back of the fixture.</div> 	<div>XXX</div> <div>1-120 in.</div>

⚙ Features & Benefits

- Complete fixture includes factory pre-wired end piece for easy and fast installation
- Flawless, continuous smooth glow of light with no inconsistencies
- Chamfered edged back effortlessly directs the channel into the milled slot, ensuring swift and hassle-free installation
- Retention ridges inside the profile securely hold the light engine in place, ensuring a smooth and straightforward installation
- External retention ridges grip the wood or particle board to securely hold the channel in place
- Create a precise 5/32 in. hole along the V-grooved drill guide for power access exactly where needed, or neatly route wires through the channel's end.
- Superior color rendering
- High R9 and R13 values
- 2-step MacAdam ellipse for unparalleled quality and consistency
- Complete UL Listed Luminaire

📏 Dimensions

Fixture Cross Section

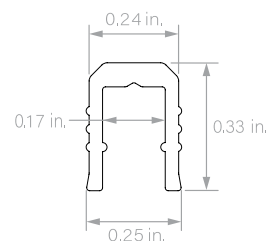

Fixtures are supplied with Optique's remote Universal power supply supporting 0-10, 1-10V, MLV, ELV dimming and voltage input from 100V-277V.

Millwork - Recessed - 90° Mounting Angle

Specification Submittal

Fixture Configuration Upon Delivery

All fixtures are shipped **pre-configured for easy installation**. Each unit includes a **Factory Pre-Wired End Piece**, ensuring a clean and efficient wire management solution. This feature eliminates the need for additional wiring through the channel, allowing for a streamlined installation process.

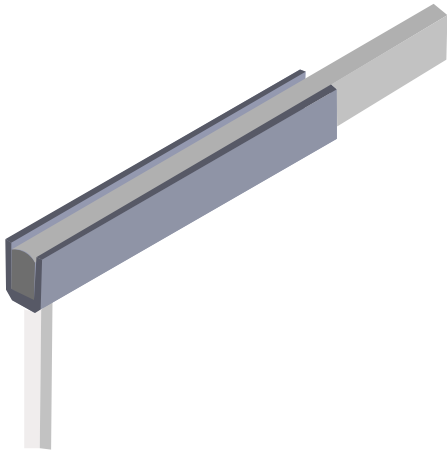

Factory Pre-Wired End Piece

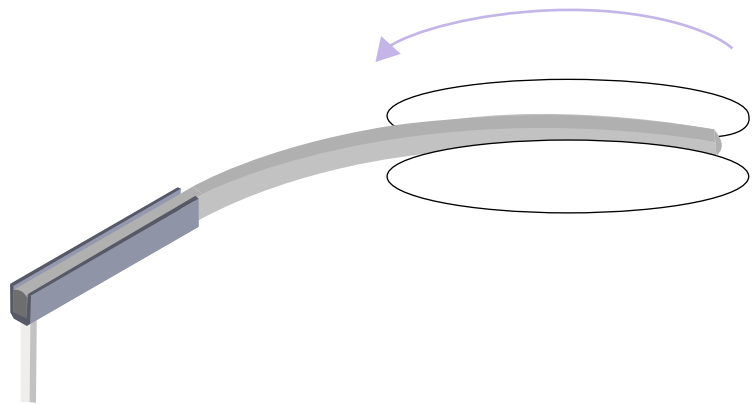

Light engine roll with Factory Pre-Wired End Piece

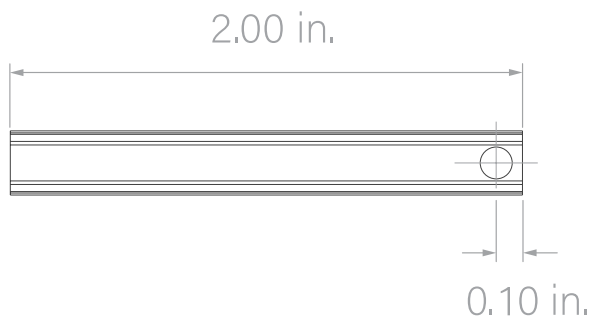

Factory Pre-Wired End Piece Back View Dimensions

Millwork - Recessed - 90° Mounting Angle

Specification Submittal

Output

Indoor

White Light

L-Level		L1
Lumens (per ft.)	2700K	122
	3000K	123
	3500K	133
	4000K	143
Wattage (per ft.)		3.4
Max Run Length* (ft.)		21.25
Closet Rated		✓

*Maximum individual fixture per power feed.

Photometry

1 ft., 3000K Millwork - Recessed - 90° Mounting Angle - Fixture

LUMEN SUMMARY

Zone	Lumens	% Fixture
0° – 15°	8.94 lm	7.27%
0° - 30°	32.8 lm	26.66%
0° - 45°	64.2 lm	52.19%
0° - 60°	94.2 lm	76.58%
0° - 75°	115 lm	93.49%
0° - 90°	121 lm	98.37%

ANGULAR DISTRIBUTION 0 – 90°

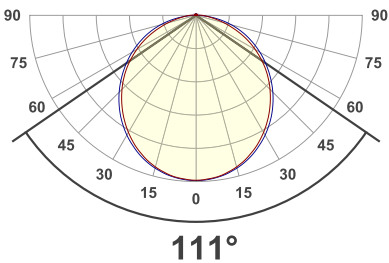

COLOR VECTOR GRAPHIC

Hue Bin	R _f	Graphic shifts (%)	
		Chroma	Hue
1	97	0%	0%
2	98	1%	-1%
3	96	1%	-1%
4	96	-1%	-2%
5	98	-1%	1%
6	97	2%	1%
7	96	1%	1%
8	95	3%	0%
9	96	2%	0%
10	96	2%	-1%
11	96	2%	0%
12	94	3%	-2%
13	95	1%	-4%
14	94	3%	-4%
15	95	1%	-2%
16	92	2%	-6%

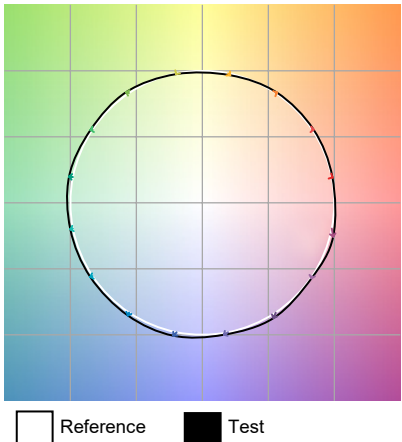



Millwork - Recessed - 90° Mounting Angle

Specification Submittal

i System Builder for Channel Only

Prefix	End Caps	Finish	Mounting	Length
OP-RMW90	NA	ALU	NM	XXX Length in 1 in. increments

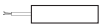
i System Builder for Light Engine Only

Prefix	Location	Output	Voltage	CCT	Length	# of Leads	Lead Length 1	Lead Length 2
OP-01-N04MMSB	O	100	24V	White Light 2700K 3000K 3500K 4000K	XXX Length in 1 in. increments	1LEAD One lead  2LEAD Two leads (one at each end)  <i>By default leads come out the end of the Light engine as shown in the image</i> 	XXX 1-120 in.	XXX 1-120 in. Optional

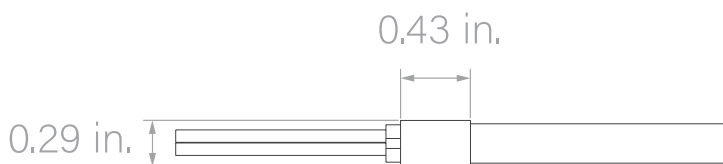

Light Engine with Sleeve

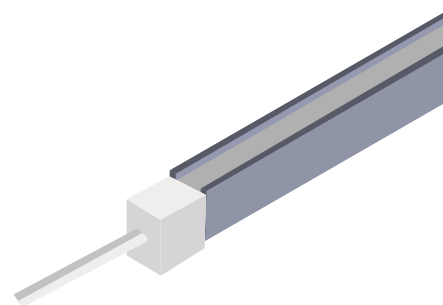

Light Engine Sleeve stays outside the channel

Millwork - Recessed - 90° Mounting Angle

Specification Submittal

i Stock SKU's for Channel

SKU	Description
OP-RMW90-NA-ALU-NM-48	Millwork - Recessed - 90 Degree Mounting Angle, Anodized Aluminum Finish, 48 in. length

i Stock SKU's for Light Engine

SKU	Description
OP-01-N04MMSB-O-100LM-24V-2700K-25	25 in. NanoNeon - 100 Lumens per foot - 2700K - 24V
OP-01-N04MMSB-O-100LM-24V-3000K-25	25 in. NanoNeon - 100 Lumens per foot - 3000K - 24V
OP-01-N04MMSB-O-100LM-24V-3500K-25	25 in. NanoNeon - 100 Lumens per foot - 3500K - 24V
OP-01-N04MMSB-O-100LM-24V-4000K-25	25 in. NanoNeon - 100 Lumens per foot - 4000K - 24V
OP-01-N04MMSB-O-100LM-24V-2700K-37	37 in. NanoNeon - 100 Lumens per foot - 2700K - 24V
OP-01-N04MMSB-O-100LM-24V-3000K-37	37 in. NanoNeon - 100 Lumens per foot - 3000K - 24V
OP-01-N04MMSB-O-100LM-24V-3500K-37	37 in. NanoNeon - 100 Lumens per foot - 3500K - 24V
OP-01-N04MMSB-O-100LM-24V-4000K-37	37 in. NanoNeon - 100 Lumens per foot - 4000K - 24V
OP-01-N04MMSB-O-100LM-24V-2700K-48	48 in. NanoNeon - 100 Lumens per foot - 2700K - 24V
OP-01-N04MMSB-O-100LM-24V-3000K-48	48 in. NanoNeon - 100 Lumens per foot - 3000K - 24V
OP-01-N04MMSB-O-100LM-24V-3500K-48	48 in. NanoNeon - 100 Lumens per foot - 3500K - 24V
OP-01-N04MMSB-O-100LM-24V-4000K-48	48 in. NanoNeon - 100 Lumens per foot - 4000K - 24V
OP-01-N04MMSB-O-100LM-24V-2700K-97	97 in. NanoNeon - 100 Lumens per foot - 2700K - 24V
OP-01-N04MMSB-O-100LM-24V-3000K-97	97 in. NanoNeon - 100 Lumens per foot - 3000K - 24V
OP-01-N04MMSB-O-100LM-24V-3500K-97	97 in. NanoNeon - 100 Lumens per foot - 3500K - 24V
OP-01-N04MMSB-O-100LM-24V-4000K-97	97 in. NanoNeon - 100 Lumens per foot - 4000K - 24V
OP-01-N04MMSB-O-100LM-24V-2700K-125	125 in. NanoNeon - 100 Lumens per foot - 2700K - 24V
OP-01-N04MMSB-O-100LM-24V-3000K-125	125 in. NanoNeon - 100 Lumens per foot - 3000K - 24V
OP-01-N04MMSB-O-100LM-24V-3500K-125	125 in. NanoNeon - 100 Lumens per foot - 3500K - 24V
OP-01-N04MMSB-O-100LM-24V-4000K-125	125 in. NanoNeon - 100 Lumens per foot - 4000K - 24V
OP-01-N04MMSB-O-100LM-24V-2700K-196	1 spool of 16.4 ft. NanoNeon - 100 Lumens per foot - 2700K - 24V
OP-01-N04MMSB-O-100LM-24V-3000K-196	1 spool of 16.4 ft. NanoNeon - 100 Lumens per foot - 3000K - 24V
OP-01-N04MMSB-O-100LM-24V-3500K-196	1 spool of 16.4 ft. NanoNeon - 100 Lumens per foot - 3500K - 24V
OP-01-N04MMSB-O-100LM-24V-4000K-196	1 spool of 16.4 ft. NanoNeon - 100 Lumens per foot - 4000K - 24V