

Millwork - Surface Mount - 45° Mounting Angle

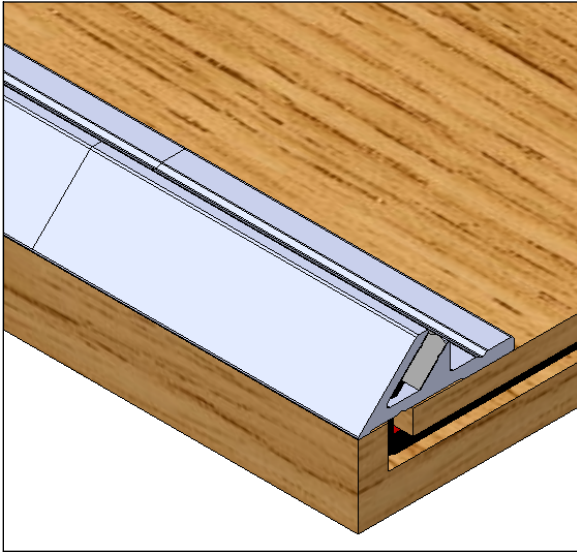

Millwork - Surface Mount - 45° Mounting Angle is designed with woodwork and millwork in mind. This innovative luminaire seamlessly integrates beneath shelves, counters, and desks. Its angled profile ensures optimal illumination, while the front lip blends seamlessly with the shelf edge for a discreet, low-visibility installation. Engineered for effortless installation with a notched drill guide for power access and retention ridges that securely hold the light engine in place.

Required Tools

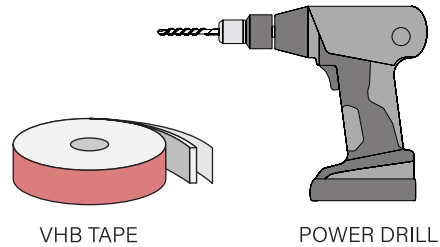

VHB TAPE

POWER DRILL

Supplied Components

The following items may vary according to the configuration, and will be provided as applicable.

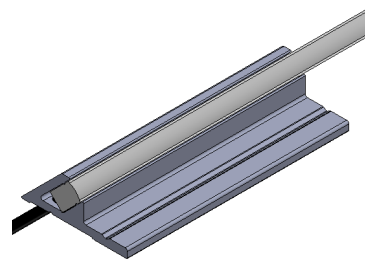
FACTORY PRE WIRED
END PIECE

Important Information

1. This product is intended to be mounted on the underside of shelves, counters, and desks.
2. This product requires a 24V DC Class 2 power supply.
3. Suitable for installation in the storage area of a clothes closet in the USA only.

Millwork - Surface Mount - 45° Mounting Angle

✂ Factory pre wired end piece Installation steps

01.

Position the 24V DC Class 2 power supply in a suitable location within 30 feet of the desired fixture location.

NOTE: Longer distances are acceptable when using a thicker 12 AWG wire.

02.

Bring 24V low-voltage in-wall rated wires to the desired fixture location.

03.

Route an opening on the edge of the wood from where you want to mount the channel to the end of the shelf large enough for lead wires to pass through.

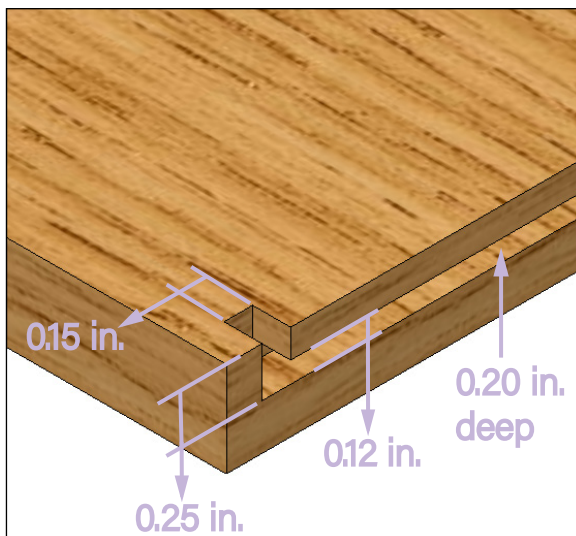

04.

Mount the channel with either VHB tape or #6 wood screws.

Option one:

Using the V-groove drill guide, secure the channel with a #6 wood screw.

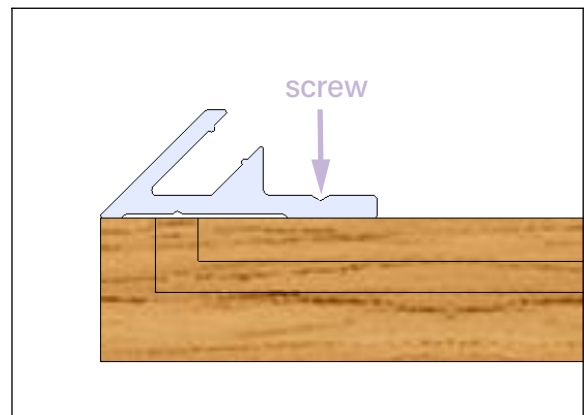

Option two:

Apply VHB tape to the back surface of the channel.

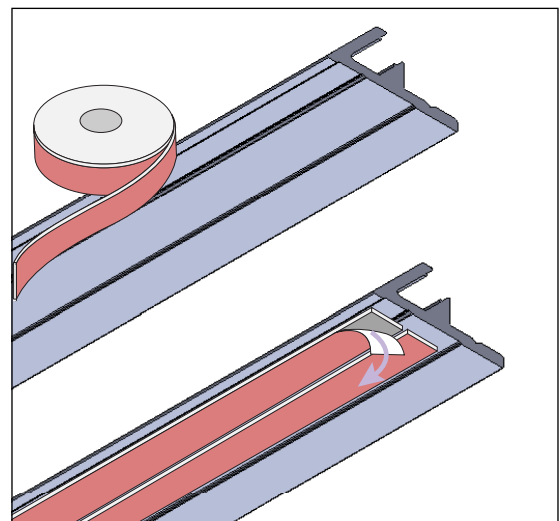

Millwork - Surface Mount - 45° Mounting Angle

05.

With the VHB tape facing to the shelf, press the channel firmly where you want to install it. Positioned 2 in. from the side edge.

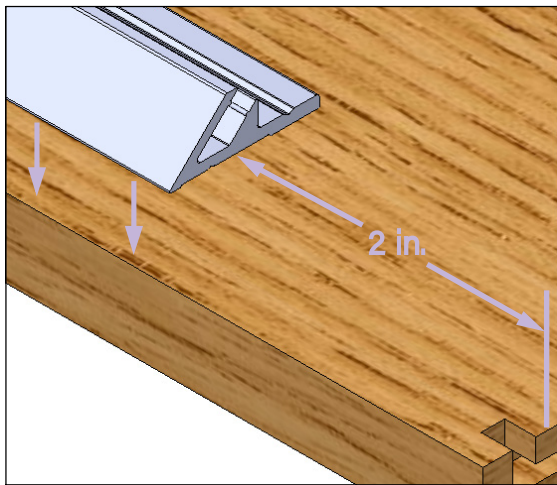
**06.**

Install the factory pre wired end piece, and gently press the Nano Neon into the channel. The retention ridges inside the channel hold the tape in place.

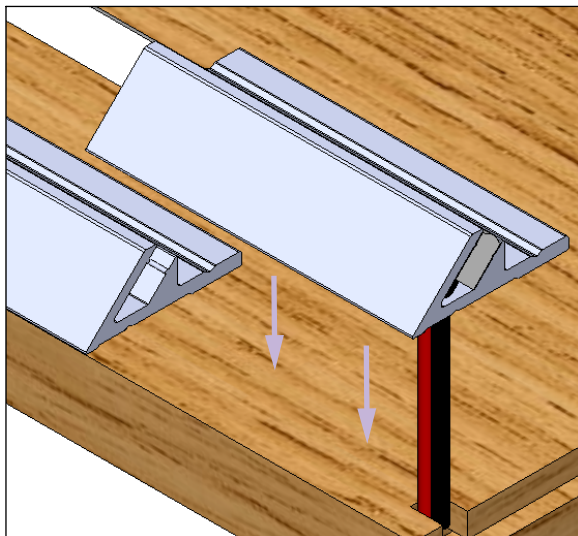
**07.**

Feed the tape light lead wire through the pre-cut hole and connect it to the low-voltage in-wall rated wires.

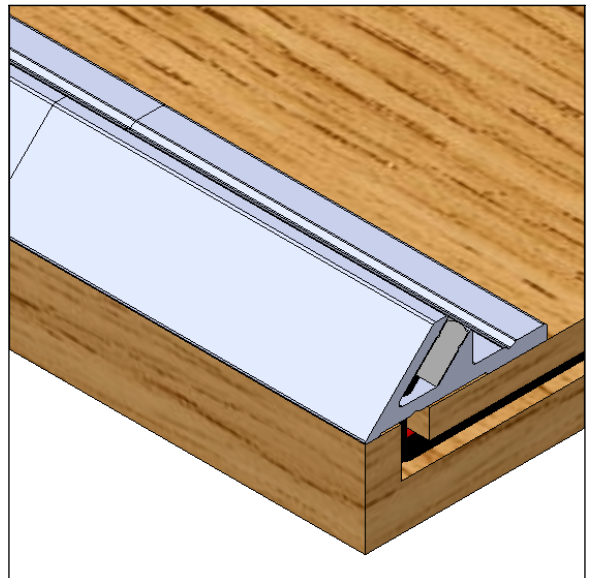
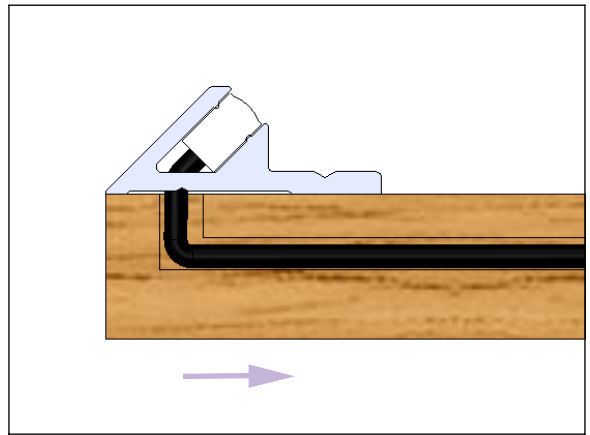

Millwork - Surface Mount - 45° Mounting Angle

✂ Without factory pre wired end piece Installation steps

01.

Position the 24V DC Class 2 power supply in a suitable location within 30 feet of the desired fixture location.

NOTE: Longer distances are acceptable when using a thicker 12 AWG wire.

02.

Bring 24V low-voltage in-wall rated wires to the desired fixture location.

03.

Route an opening on the edge of the wood from where you want to mount the channel to the end of the shelf large enough for lead wires to pass through.

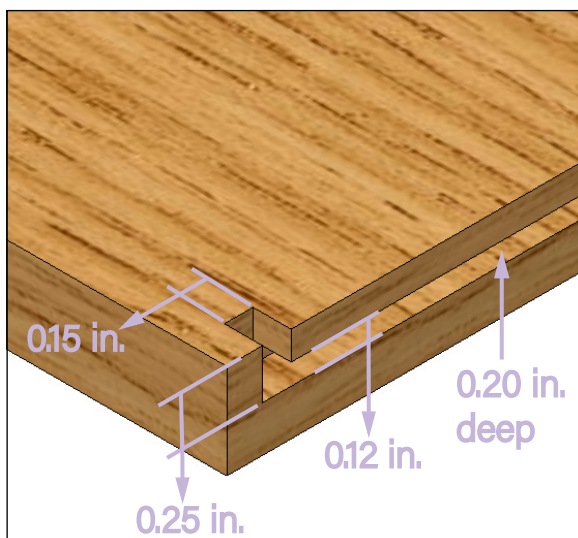

04.

Mount the channel with either VHB tape or #6 wood screws.

Option one:

Using the V-groove drill guide, secure the channel with a #6 wood screw.

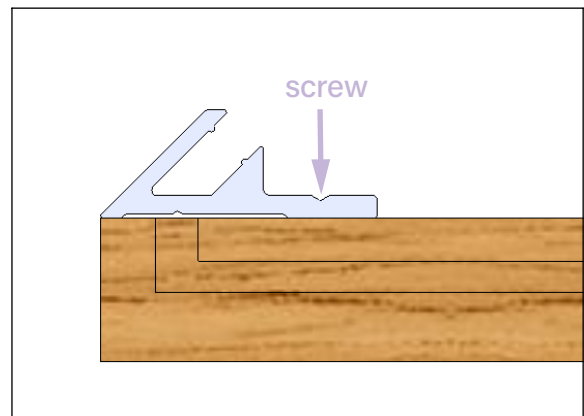

Option two:

Apply VHB tape to the back surface of the channel.

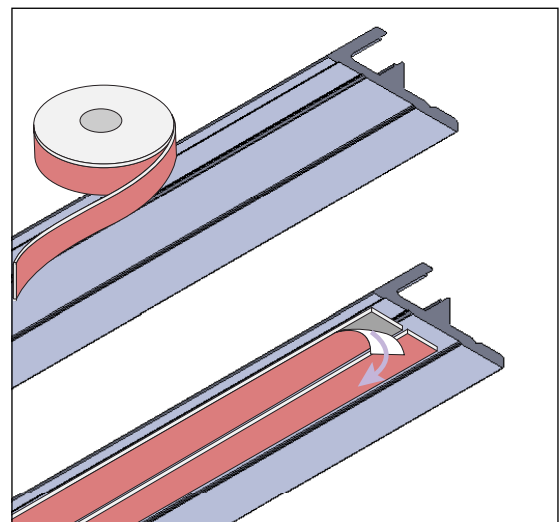

Millwork - Surface Mount - 45° Mounting Angle

05.

With the VHB tape facing to the shelf, press the channel firmly where you want to install it. Positioned 0.8 in. from the side edge.

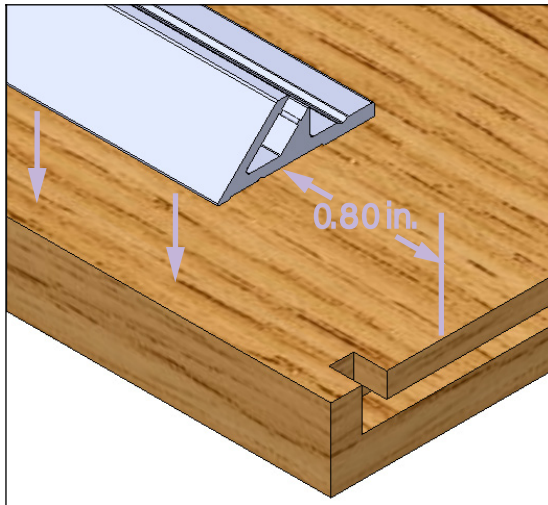

06.

Gently press Nano Neon into the channel. Retention ridges inside the channel hold the tape in place.

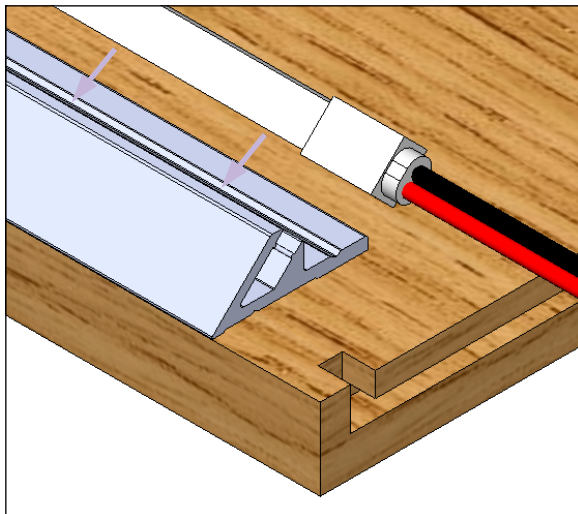

07.

Feed the tape light lead wire through the pre-cut hole and connect it to the low-voltage in-wall rated wires.

