

# Perifina Curved Corner 3 & 4 in.

Recessed Mud-In Corner Cove Luminaire

OPTIQUE

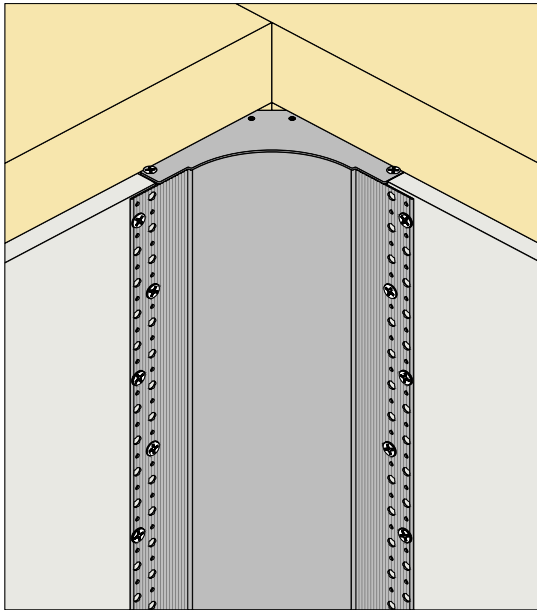

Illuminates wall-to-wall and wall-to-ceiling corners

## Important Information

1. Perifina Curved Corner 3 in. compatible with 1/2 inch and 5/8 inch drywall.
2. Perifina Curved Corner 4 in. compatible with 5/8 inch drywall.
3. Ensure that the product you are using is compatible with your drywall thickness.
4. This product requires a 24V DC Class 2 power supply.
5. Use the larger screw hole to attach the LED channel to the drywall instead of the smaller screw holes.
6. Be careful not to over-tighten the screws; tighten them just enough to secure the channel without compressing it.
7. This product can span lengths that are wall-to-wall, or be specified in shorter sections for sconce-like applications.

## Required Tools

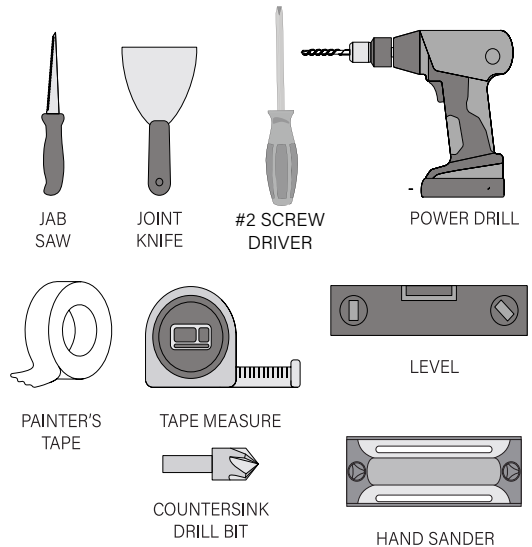

## Supplied Components

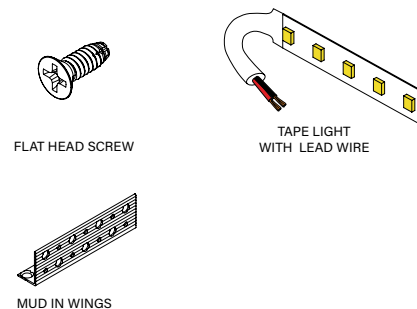

The following items may vary according to the configuration, and will be provided as applicable.

# Perifina Curved Corner 3 & 4 in.

## Recessed Mud-In Corner Cove Luminaire

### Complete Run Installation steps

#### 01.

Position the 24V DC Class 2 power supply in a suitable location within 30 feet of the desired fixture location.

NOTE: Longer distances are acceptable when using a thicker 12 AWG wire.

#### 02.

Bring 24V low-voltage in-wall rated wires to the desired fixture location.

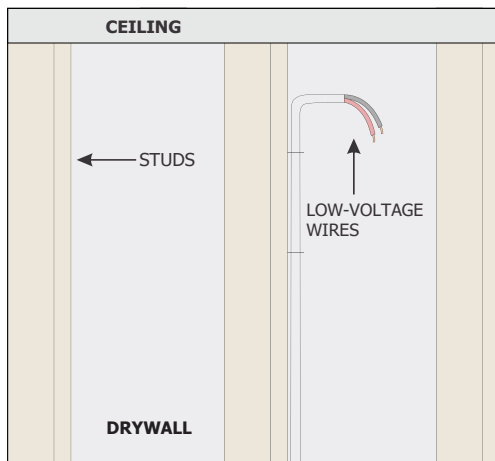

#### 03.

Cut an opening in the drywall where you would like to mount Perifina Curved Corner based on measurements below.

\* Profile width varies between models.

- Perifina Curved Corner 3 in: 3.5in
- Perifina Curved Corner 4 in: 4.7in

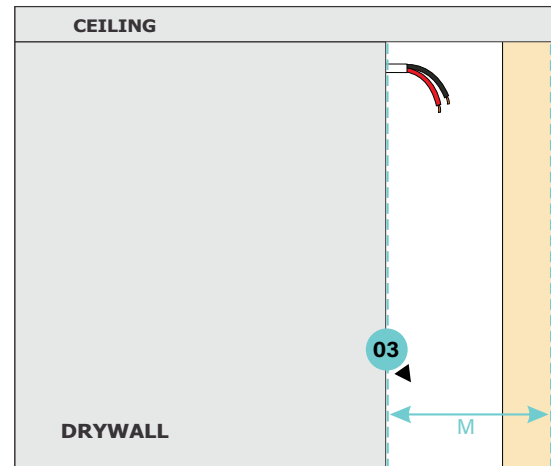

#### 04.

Cut an opening in the drywall next to your previous cut.

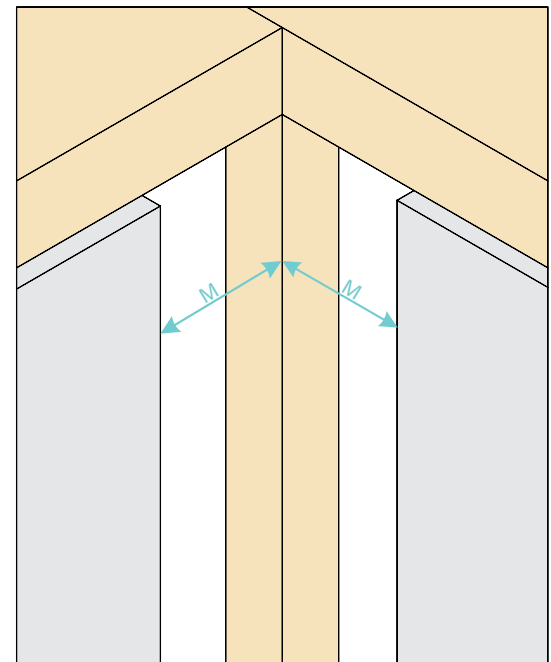

NOTE: Mark the location of the studs on the drywall for the future reference.

# Perifina Curved Corner 3 & 4 in.

Recessed Mud-In Corner Cove Luminaire

## ✂ Complete Run: Installation

### 05.

Drill two 1/4 inch holes in the back of the Perifina Curved Corner channel at the location indicated below. One hole on each side. These holes will be used for power feeds.

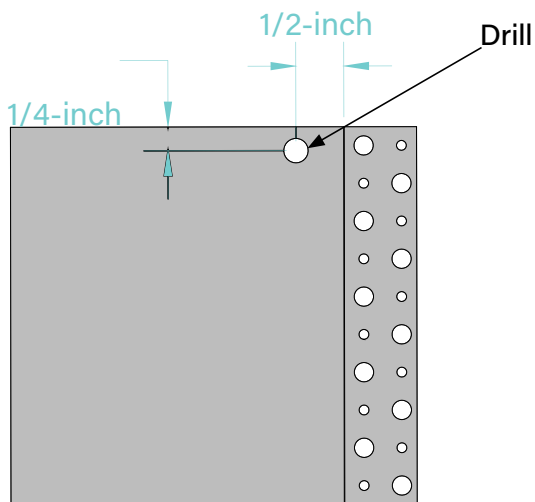

a. Deburr sharp edges from both holes and make sure holes are the right size.

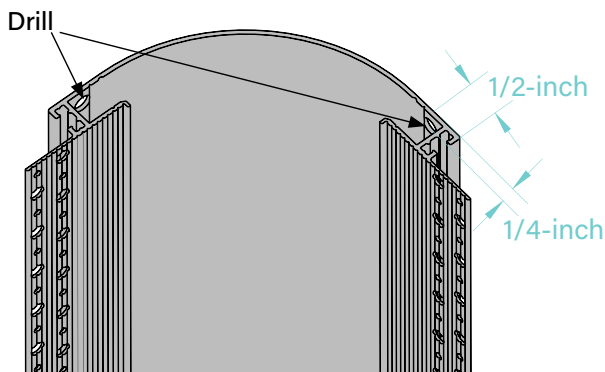

### 06.

Assemble the endcaps with provided Phillips head screws on both ends using a #2 screw driver.

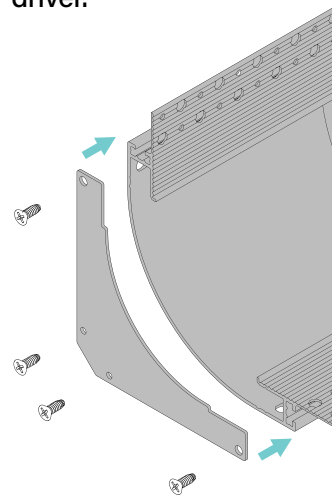

### 07.

Place the assembled Perifina Curved Corner fixture into the drywall. Make sure it fits firmly in the drywall.

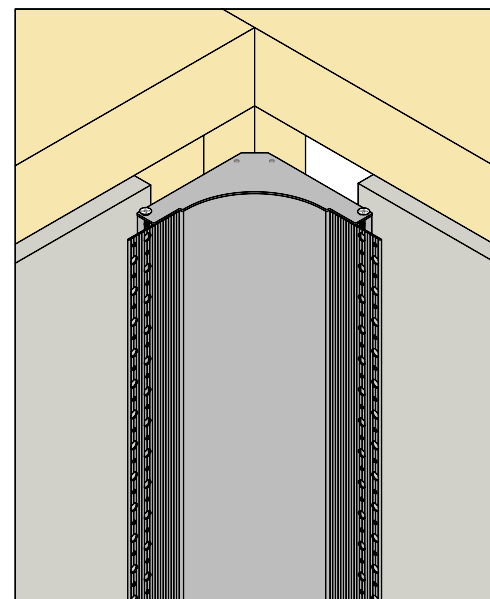

# Perifina Curved Corner 3 & 4 in.

## Recessed Mud-In Corner Cove Luminaire

### 08.

Connect tape light lead to low-voltage in-wall rated wire. Red is positive (+) and black is negative (-).

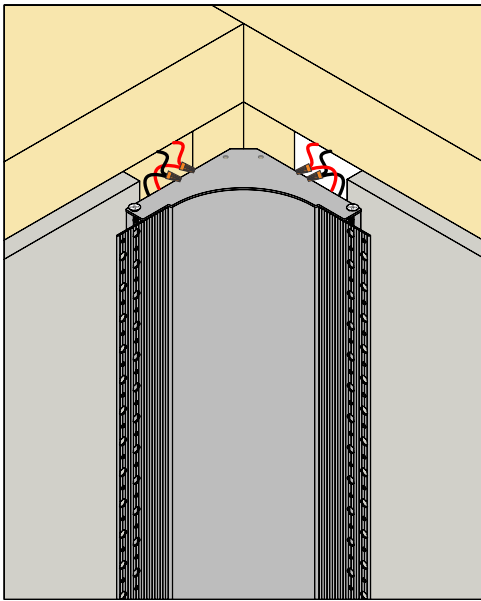

a. Pass the connected low-voltage wires behind the channel.

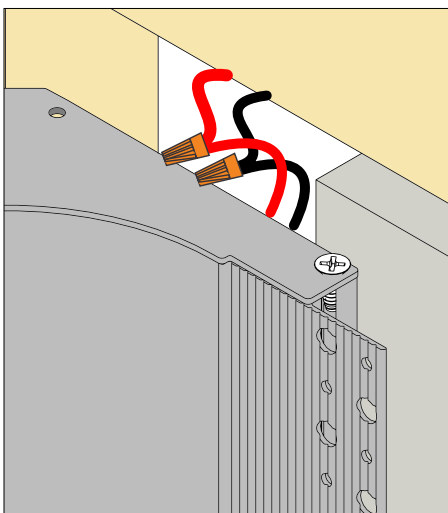

### 09.

Pre-drill holes using countersink drill bit along fixture. Suggested spacing is every 4". Secure channel by using standard drywall screws through pre-drilled holes.

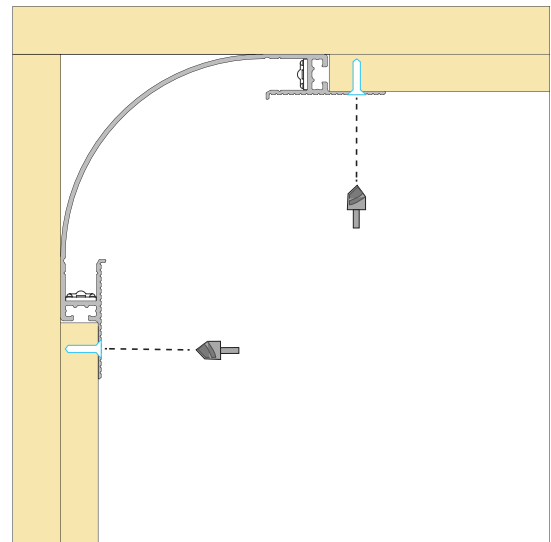

a. Carefully make countersunk holes on the other side of the fixture

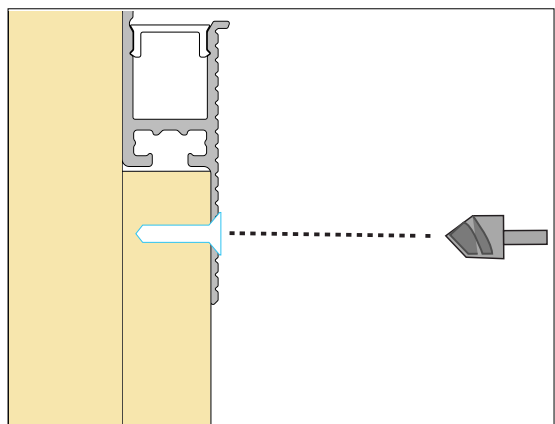

**NOTE:** Deburr sharp edges.

**NOTE:** Cover the fixture inside with painter's tape before plastering to prevent plaster and dust entering inside the fixture.

# Perifina Curved Corner 3 & 4 in.

## Recessed Mud-In Corner Cove Luminaire

10.

Secure the fixture to the drywall with the drywall screws. Suggested screw spacing is 4 inch.

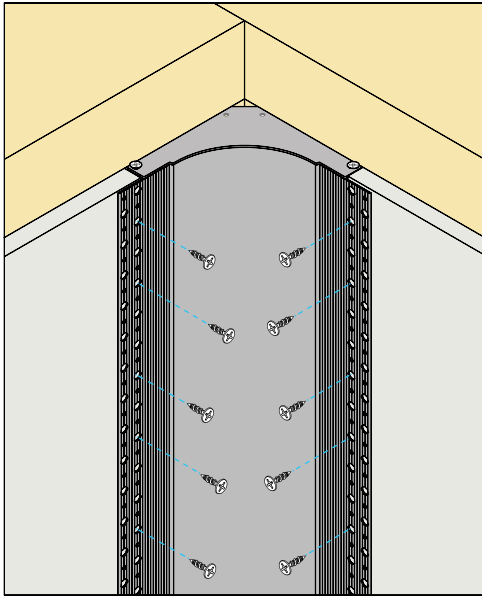

a. Make sure the fixture is secured firmly against the drywall.

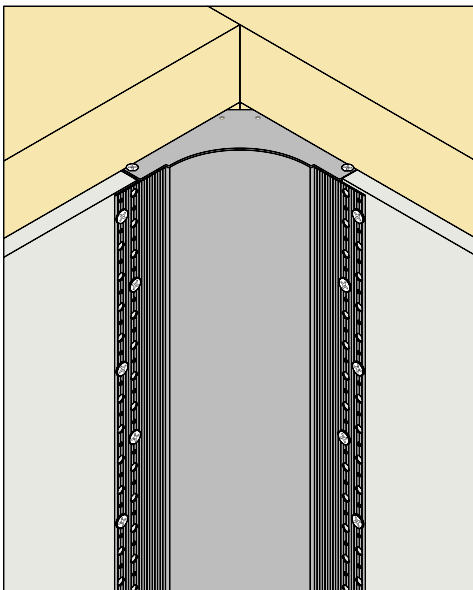

11.

Apply drywall tape along edges of the fixture to prevent cracking of plaster after installation.

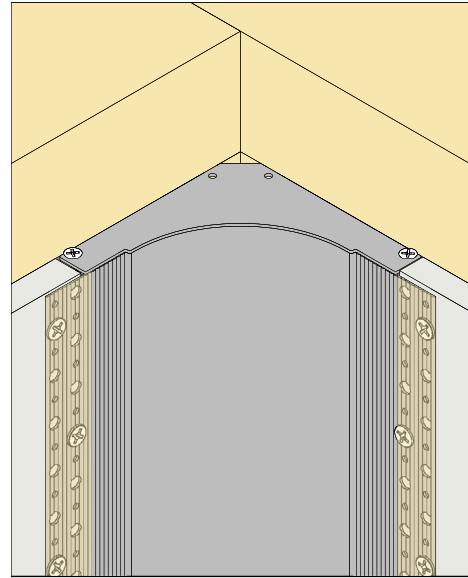

12.

Apply drywall joint compound over the fixture's flanges. Finish the wall.

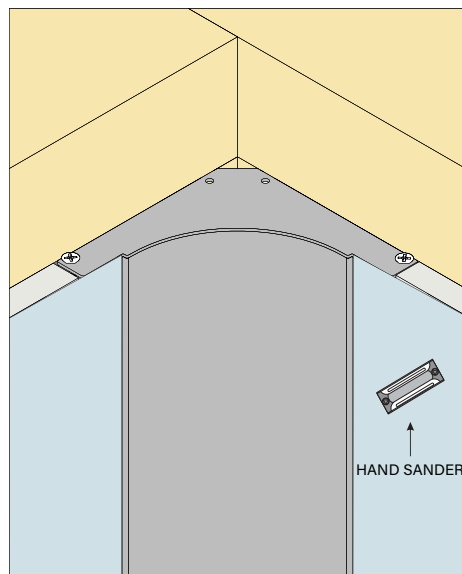

# Perifina Curved Corner 3 & 4 in.

Recessed Mud-In Corner Cove Luminaire

**13.**

Remove the painter's tape and clean if necessary.

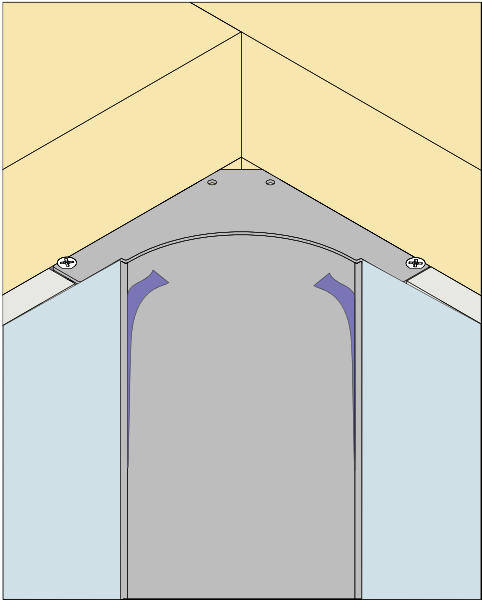

**14.**

Affix the lens by gently snapping into place. Ensure it is fully seated. Turn on lights to check the LED tape is working properly.

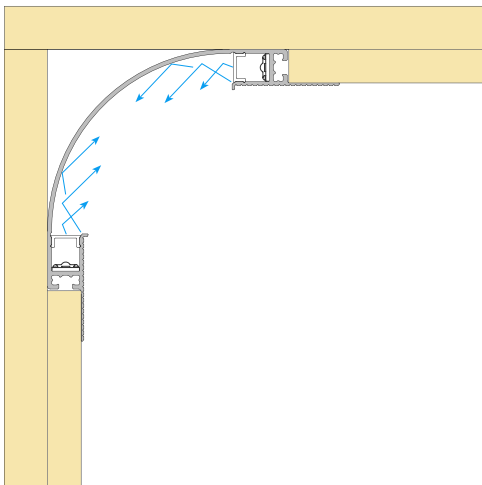

# Perifina Curved Corner 3 & 4 in.

## Recessed Mud-In Corner Cove Luminaire

### ✂ Short Run: Installation steps

#### 15.

Drill two 1/4 inch holes in the back of the Perifina Curved Corner channel at the location indicated below. One hole on each side. These holes will be used for power feeds.

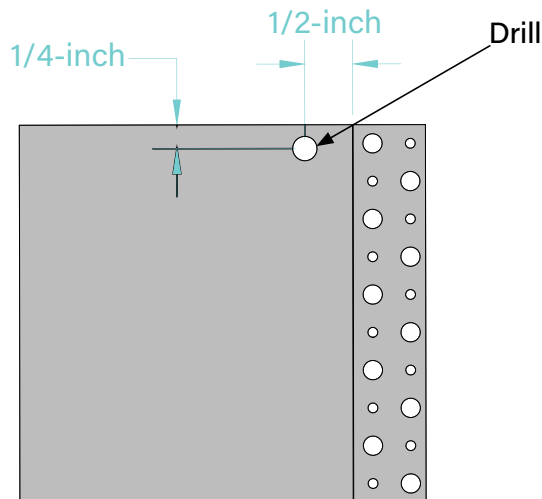

b. Deburr sharp edges from both holes.

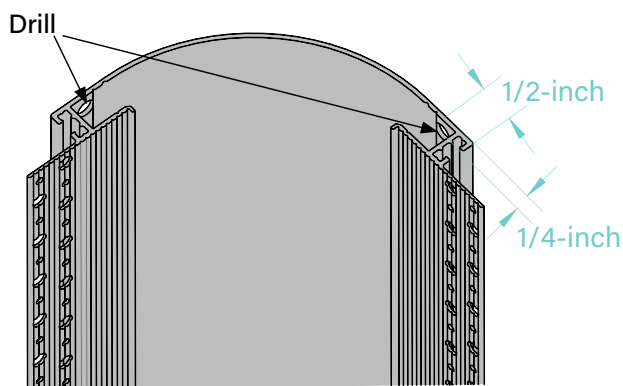

#### 16.

Assemble the end caps and mud-in flanges with the provided Philip head screws on both ends using a #2 screw driver.

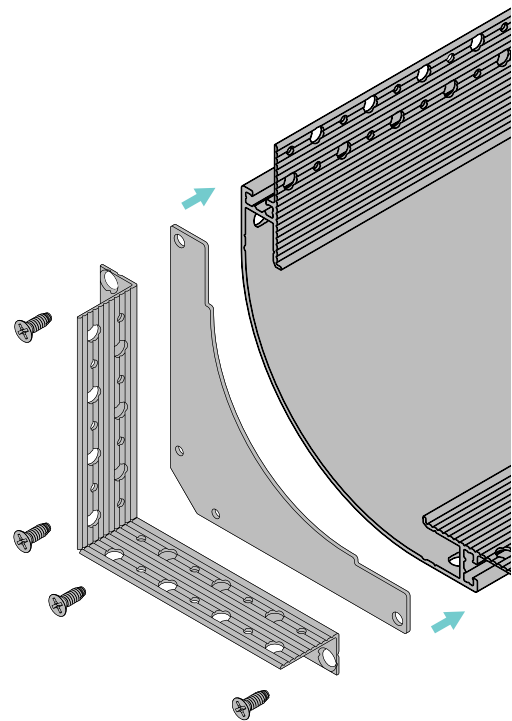

# Perifina Curved Corner 3 & 4 in.

## Recessed Mud-In Corner Cove Luminaire

### 17.

Cut an opening in the drywall where you would like to mount Perifina Curved Corner based on measurements below.

\* Profile width varies between models.

- Perifina Curved Corner 3 in: 3.5in
- Perifina Curved Corner 4 in: 4.7in

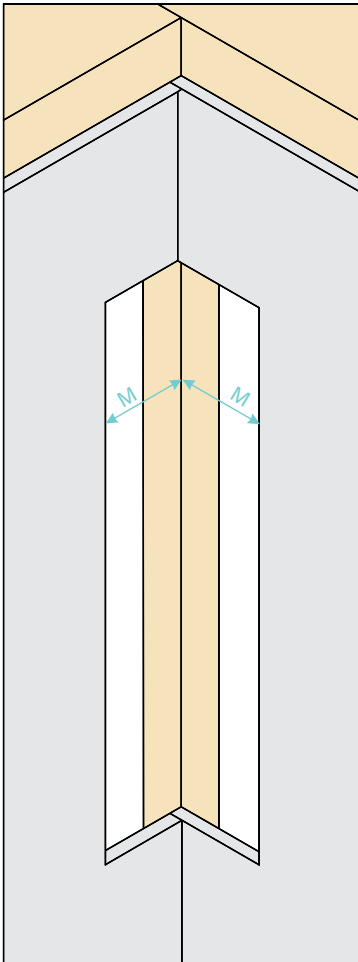

NOTE: Mark the location of the studs on the drywall for the future reference.

### 18.

Place the assembled fixture into the drywall. Make sure fits firmly in the drywall.

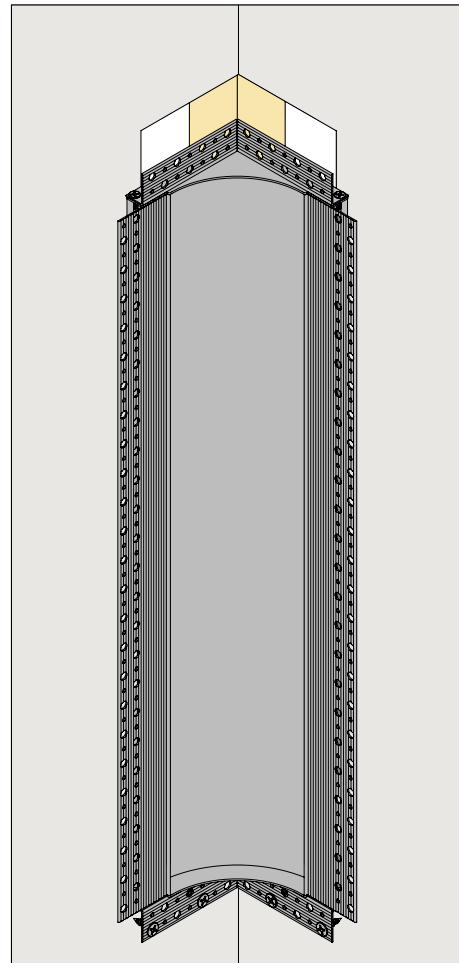



# Perifina Curved Corner 3 & 4 in.

Recessed Mud-In Corner Cove Luminaire

19.

Connect tape light leads to low-voltage in-wall rated wire. Red is positive (+) and black is negative (-).

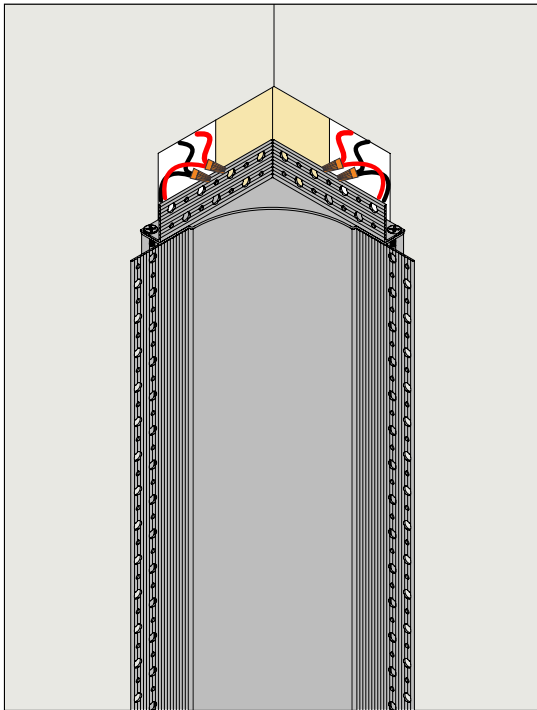

a. Pass the connected low-voltage wires behind the channel.

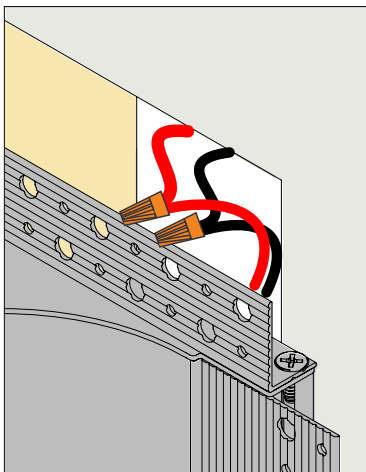

20.

Place the assembled fixture into the drywall. Make sure the fixture fits firmly in the drywall.

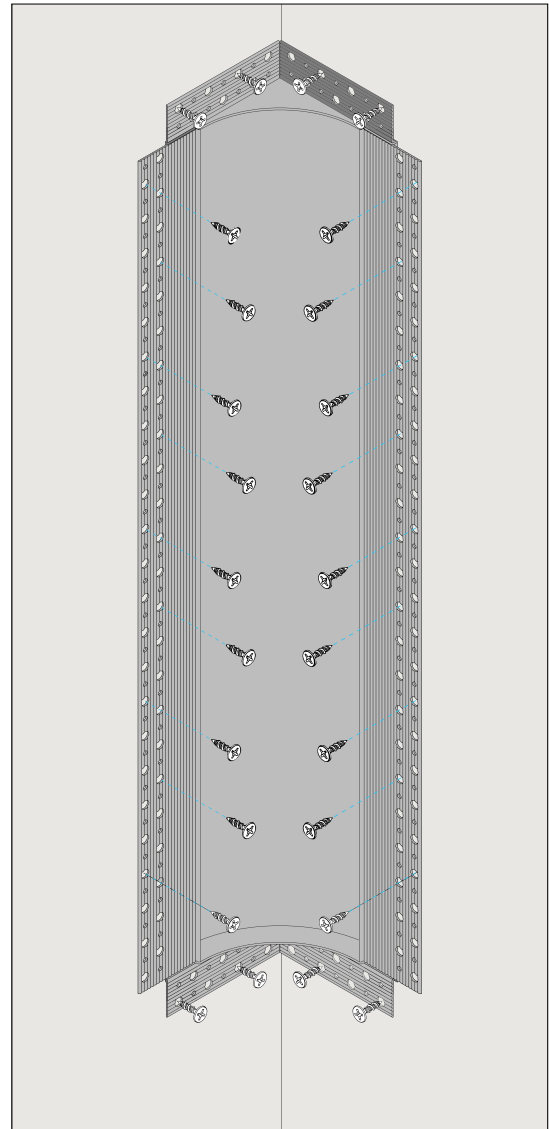

# Perifina Curved Corner 3 & 4 in.

Recessed Mud-In Corner Cove Luminaire

**21.**

Apply drywall tape along edges of the fixture to prevent cracking of joint compound after installation.

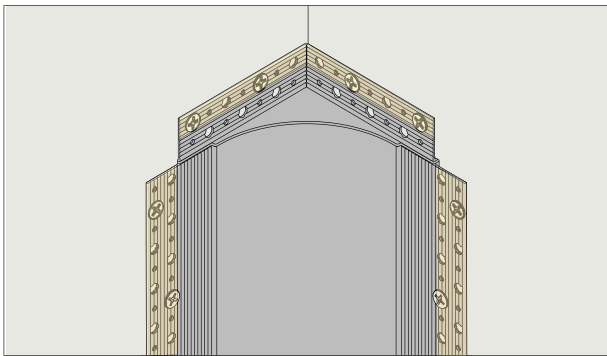

**22.**

Apply drywall joint compound over the fixture's flanges. Finish the walls properly.

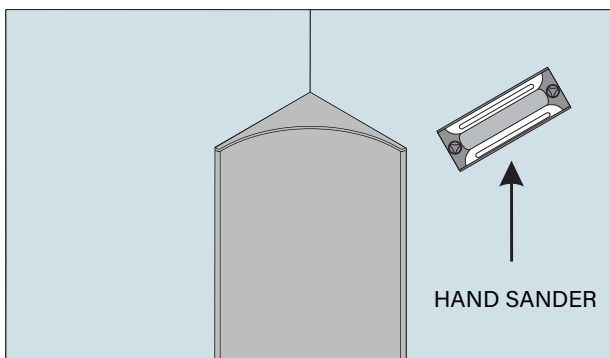

**23.**

Remove the painter's tape and clean if necessary.

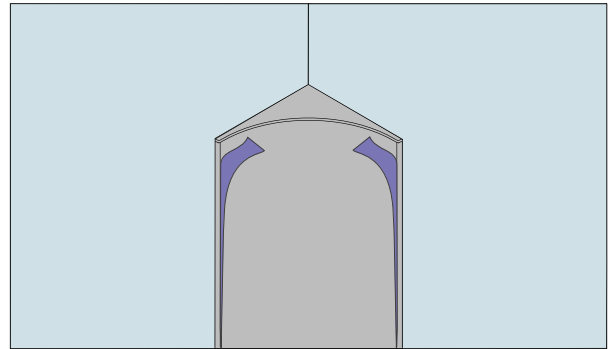

**24.**

Affix the lens by gently snapping into place. Ensure it is fully seated. Turn on lights to check the LED tape is working properly.

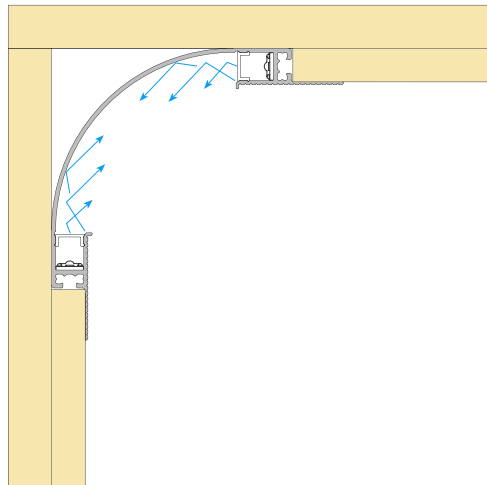

NOTE: Endcaps not shown.