

Perifina Wall Accent 3 & 4 in.

Recessed Mud-In Wall Luminaire

OPTIQUE

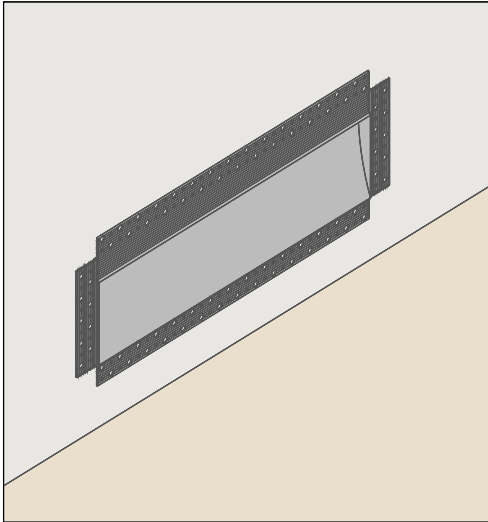

Beautifully crafted with a scoop design that creates an attractive light gradient that can easily go around corners without light gaps.



Required Tools



JAB
SAW

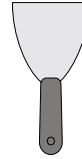

JOINT
KNIFE

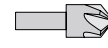

COUNTERSINK
DRILL BIT

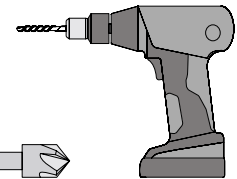

POWER DRILL

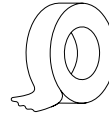

PAINTER'S
TAPE

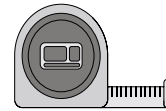

TAPE MEASURE

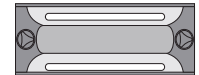

HAND SANDER



Supplied Components

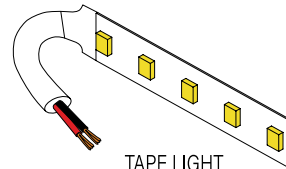

TAPE LIGHT
WITH LEAD WIRE



FLAT HEAD
SCREW

The following items may vary according to the configuration, and will be provided as applicable.



Important Information

1. Perifina Wall Accent 3 in. fits in 1/2-inch and 5/8-inch drywall.
2. Perifina Wall Accent 4 in. fits in 5/8-inch drywall.
3. Ensure that the product you are using is compatible with your drywall thickness.
4. This product requires a 24V DC Class 2 power supply.
5. Use the larger screw hole to attach the LED channel to the drywall instead of the smaller screw holes.
6. Be careful not to over-tighten the screws; tighten them just enough to secure the channel without compressing it.
7. This product can span lengths that are wall-to-wall, or be specified in shorter sections for sconce-like applications.

Perifina Wall Accent 3 & 4 in.

Recessed Mud-In Wall Luminaire

OPTIQUE

Perifina Wall Accent Installation steps

01.

Position the 24V DC Class 2 power supply in a suitable location within 30 feet of the desired fixture location.

NOTE: Longer distances are acceptable when using a thicker 12 AWG wire.

02.

Bring 24V low-voltage in-wall rated wires to the desired fixture location.

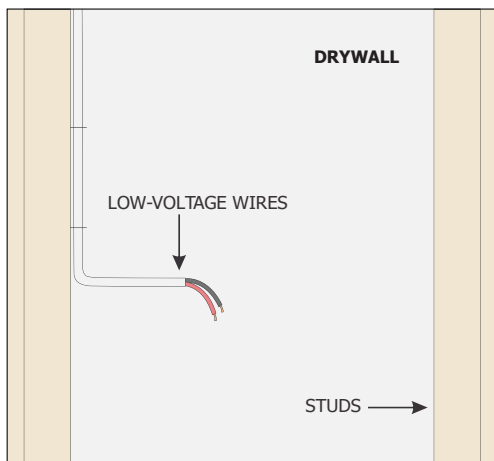

03.

Cut an opening in the drywall where you would like to mount Perifina Wall Accent based on measurements below.

Profile height varies between models.
Perifina Wall Accent 3 in: 3.5 in.
Perifina Wall Accent 4 in: 4.5 in.

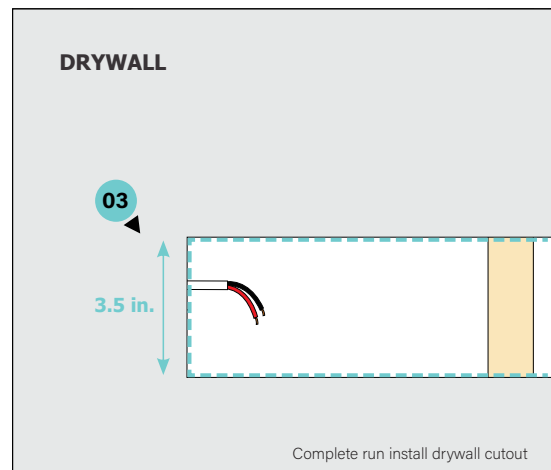

NOTE: Perifina Wall Accent 4 in. can only be used with 5/8" drywall.

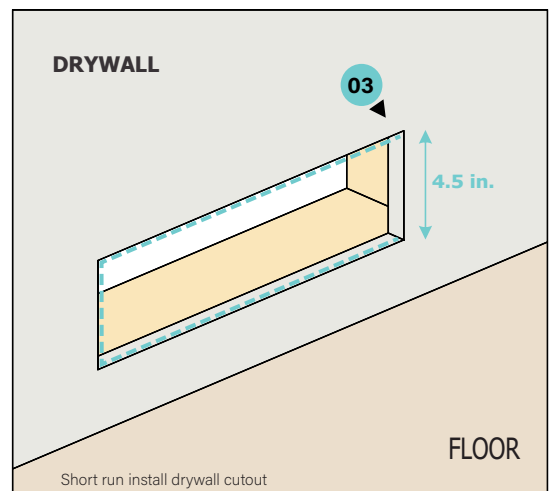

Perifina Wall Accent 3 & 4 in.

Recessed Mud-In Wall Luminaire

OPTIQUE

04.

Drill a 1/4 inch hole in the back of the fixture. This hole will be used for power feed. Deburr sharp edges.

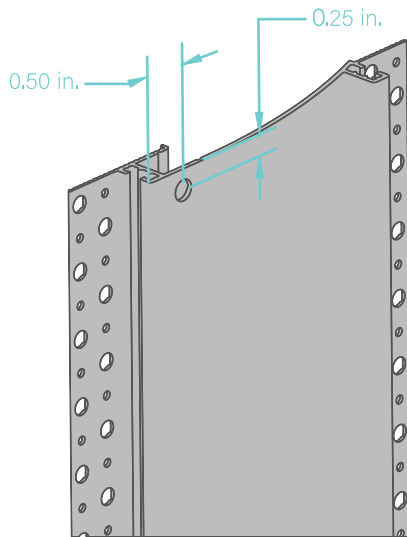

05.

Fasten the Perifina Accent end caps with the provided flat head screws on both ends.

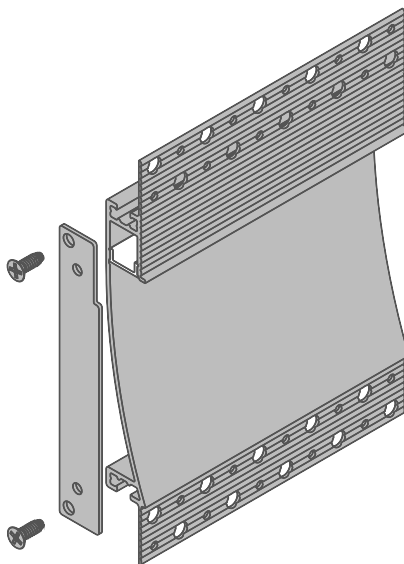

- a. Assemble mudwing to the endcaps for short runs configurations.

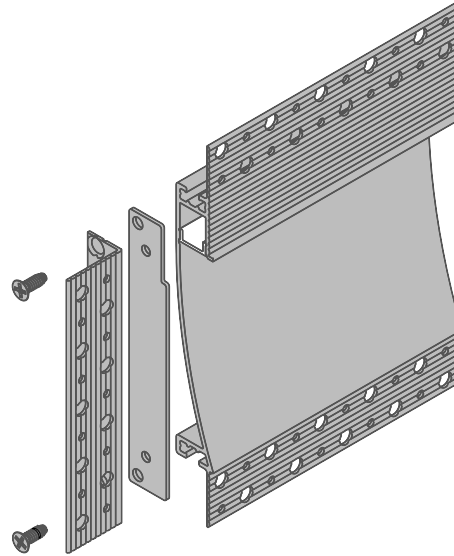

06.

Carefully countersink holes in Perifina Wall Accent using the countersink drill bit.

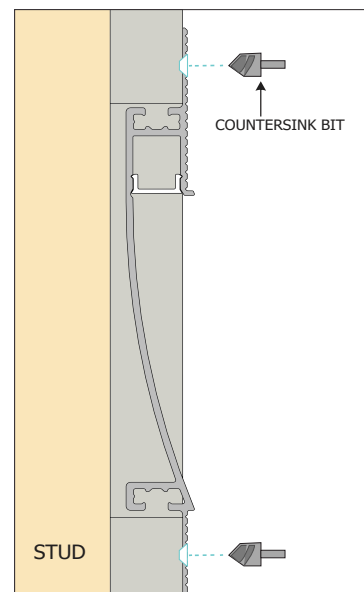

Perifina Wall Accent 3 & 4 in.

Recessed Mud-In Wall Luminaire

OPTIQUE

07.

Connect tapelight lead to low-voltage in-wall rated wire. Red is positive (+) and black is negative (-).

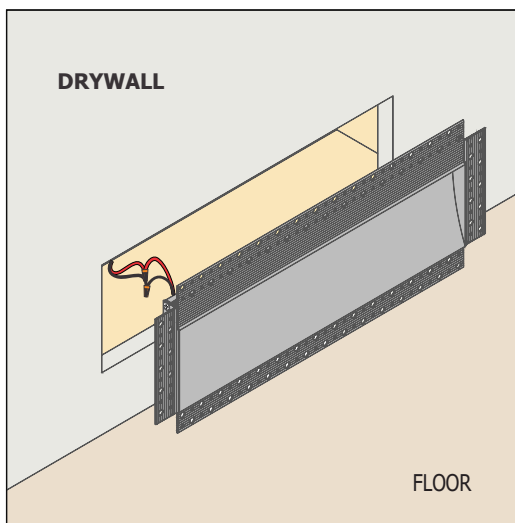

08.

Pass the connected low-voltage wires through the opening in the drywall cutout.

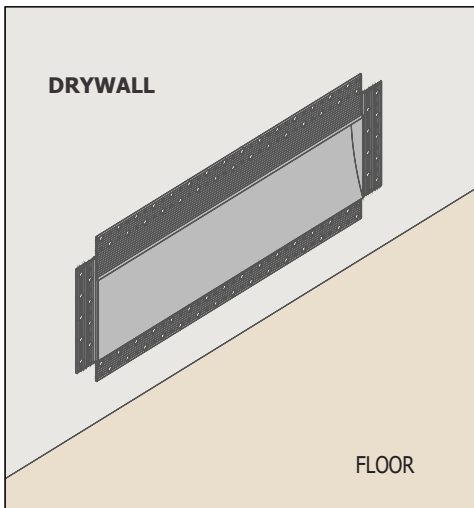

09.

Secure the fixture to the drywall using the drywall screws. The suggested screw spacing is 4 inches.

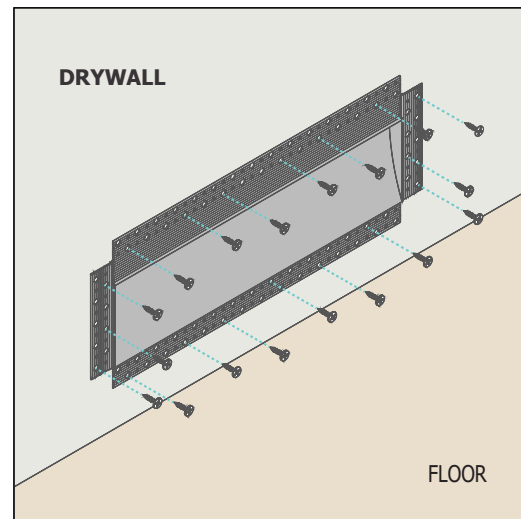

10.

Cover the inside of the fixture with painter's tape if necessary before plastering, to prevent joint compound and dust from entering.

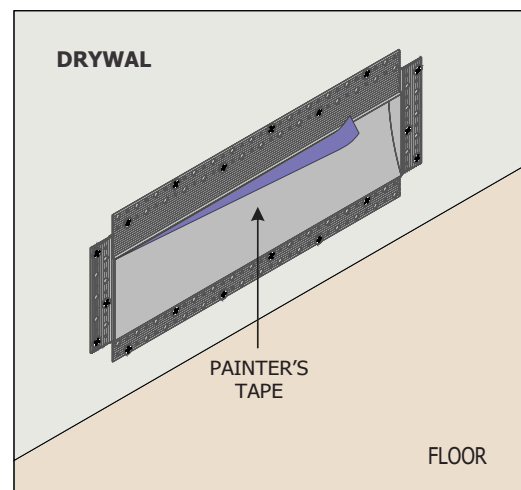

Perifina Wall Accent 3 & 4 in.

Recessed Mud-In Wall Luminaire

OPTIQUE

11.

Apply drywall tape along the edges of the fixture to prevent cracking of joint compound after installation.

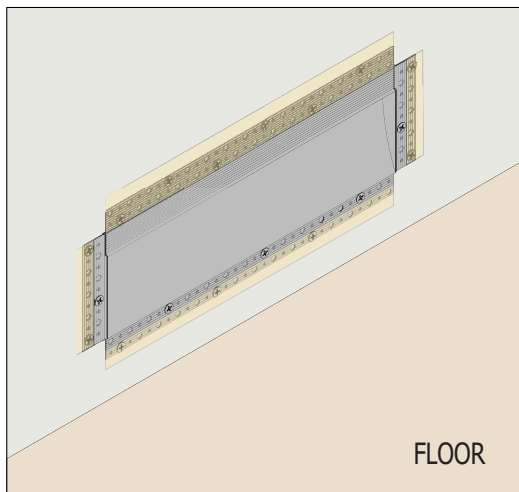

12.

Apply drywall joint compound over the fixture's flanges. Then finish the wall.

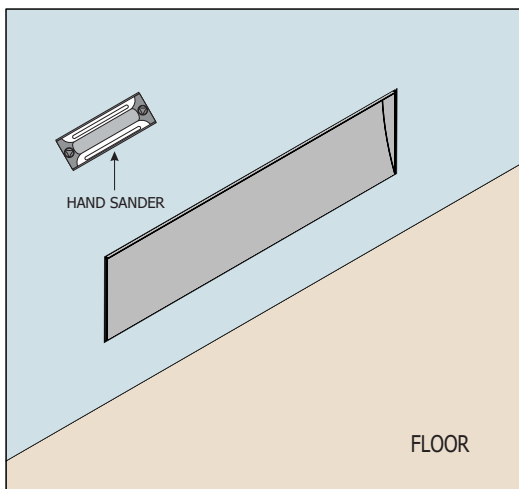

13.

Remove the painter's tape and clean if necessary.

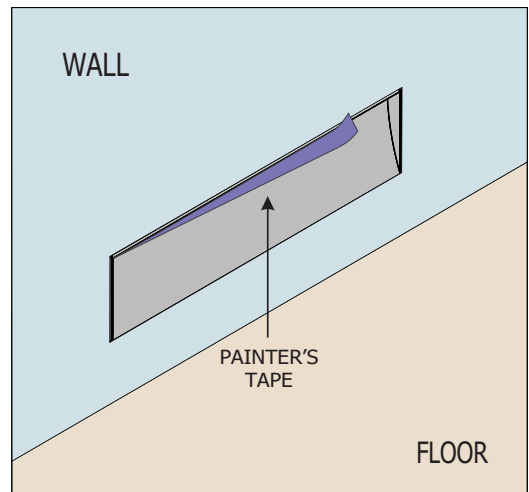

14.

Affix the lens by gently snapping into place. Ensure it is fully seated.

