

OPTIQUE

# Velino.0 T-Grid Clip-On

Lay-In 9/16" and 15/16" T-Grid Clip-On Asymmetrical - Dark Optics - Surface-Mount



## Velino.0 T-Grid Clip-On

Lay-In 9/16" and 15/16" T-Grid Clip-On

Asymmetrical - Dark Optics - Surface-Mount

### Specification Submittal

A discreet surface-mount linear luminaire precision-engineered for seamless integration into standard 9/16" and 15/16" Lay-In T-Grid ceilings. Featuring asymmetric dark optics and refined finishes, it delivers precise, glare-free beam control shielded from view—directing light exactly where it's needed while maintaining a clean, modern ceiling aesthetic.

Project Name:

Project Location:

Fixture Type:

SKUs:



### Features & Benefits

- Clip-on system for standard 9/16" and 15/16" Lay-In T-Grid ceilings for a clean, tool-free integration
- Asymmetric Dark Optics provide targeted, glare-free illumination ideal for wall-washing, signage, pathways, and visual-task emphasis
- A glare-shield conceals the light source for a comfortable, low-brightness appearance that enhances visual comfort
- Available in 4 ft. and 8 ft. lengths, or custom sizes up to 100 in. for continuous runs
- Available in anodized aluminum, matte black, gloss white, or special order RAL colors
- 24V DC operation; compatible with Triac, DALI, ELV, 0-10V, DMX, Casambi, and Silvar controls
- Factory-assembled up to 100 in. for faster installation and cost-efficient shipping
- Superior color rendering
- High R9 and R13 values
- Complete UL Listed Luminaire

### Fixture Dimensions

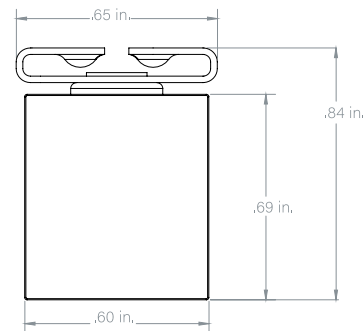

Fixture Cross Section

## Velino.0 T-Grid Clip-On

Lay-In 9/16" and 15/16" T-Grid Clip-On

Asymmetrical - Dark Optics - Surface-Mount

Specification Submittal



### i Luminaire System Builder

Prefix	Location	Mount	Optics	Output	CCT	Finish	Length	Leads	Lead Length 1	Lead Length 2
OP-SFU-V0	I	TGL916	DA							
		Options <b>TGL1516</b>	Dark Optics * <b>DA</b> Dark Optic Asymmetric - (Asymmetric beam for wall-wash)	White Light <b>L7</b> 700± lm/ft (4W) <b>L10</b> 1000± lm/ft (6W)	White Light <b>2700K</b> <b>3000K</b> <b>3500K</b> <b>4000K</b>	 <b>ALU</b> Anodized Aluminum  <b>GLW</b> Powder Coated Gloss White  <b>ABL</b> Anodized Matte Black  <b>RALXXXX</b> Specify Color	Standard Fixture Lengths** <b>XX</b> Length in 1 ft. increments  - The fixtures come in segments up to 8 ft.  <b>XXX</b> Module-length multiples	<b>1LEAD</b> One lead  <b>2LEAD</b> Two leads 	<b>XXX</b> 1-120 in.	<b>XXX</b> 1-120 in.

\*Dark optic modules are based on a fixed module length of 11.02" (280 mm).

\*\* Standard fixtures are ordered in 1 ft increments and may include non-illuminated sections (covers). Custom configurations can be specified in module-length multiples for continuous runs.

Length refers to luminaire length without endcaps. Optical modules and accessories may not align exactly with the final luminaire dimensions. End caps add additional length to the overall fixture.

# Velino.0 T-Grid Clip-On

Lay-In 9/16" and 15/16" T-Grid Clip-On

Asymmetrical - Dark Optics - Surface-Mount

Specification Submittal

**i** Canopy System Builder (Optional)

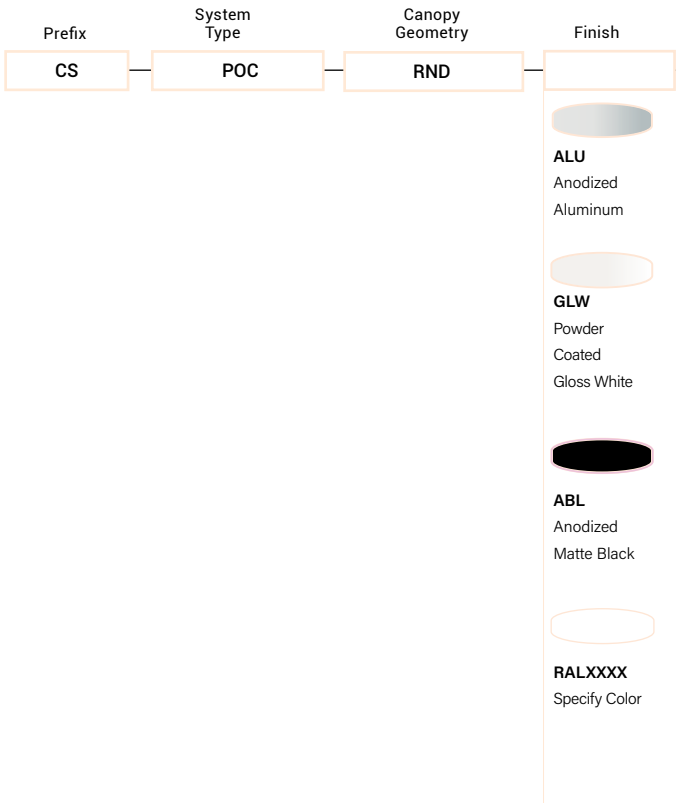

## Velino.0 T-Grid Clip-On

*Lay-In 9/16" and 15/16" T-Grid Clip-On*

*Asymmetrical - Dark Optics - Surface-Mount*

Specification Submittal

### **i** Dark Optics Options

**DA**

Dark Optic Asymmetric beam for wall-wash

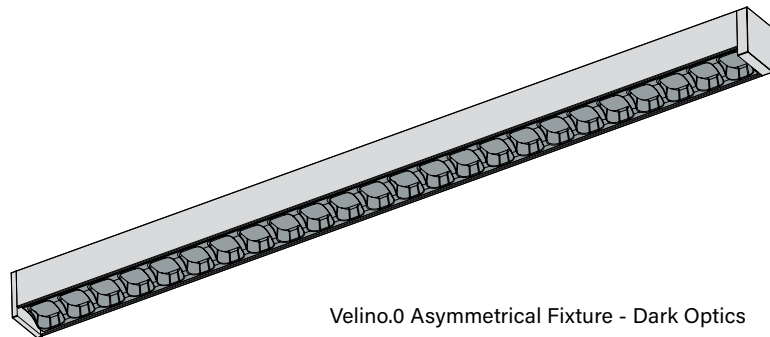
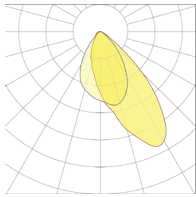

Velino.0 Asymmetrical Fixture - Dark Optics

## Velino.0 T-Grid Clip-On

*Lay-In 9/16" and 15/16" T-Grid Clip-On*

*Asymmetrical - Dark Optics - Surface-Mount*

Specification Submittal



### Output

Indoor

Output (lm/ft)	L7	L10	
<b>Lumens</b> (per ft.)	<b>2700K</b>	446.19	627.69
	<b>3000K</b>	480.89	684.70
	<b>3500K</b>	527.76	755.22
	<b>4000K</b>	547.76	769.40
<b>Wattage</b> (per ft.)	4.36	6.52	

Output (CD)	L7	L10	
<b>Candelas</b>	<b>2700K</b>	456.88	642.58
	<b>3000K</b>	491.58	702.10
	<b>3500K</b>	539.16	768.75
	<b>4000K</b>	557.77	782.08
<b>Wattage</b> (per ft.)	4.36	6.52	

# Velino.0 T-Grid Clip-On

Lay-In 9/16" T-Grid Clip-On Asymmetrical - Dark Optics - Surface-Mount

Specification Submittal

## ✦ Photometry

### LIGHT DISTRIBUTION

Velino.0 Lay-In 9/16" T-Grid Clip-On - Surface Mount

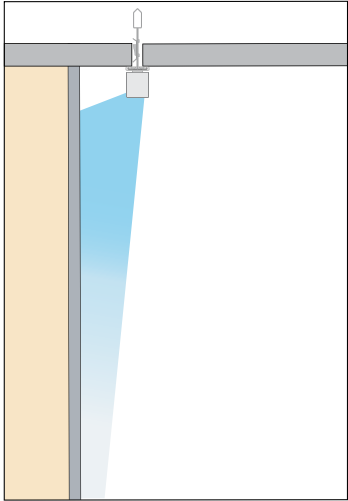

Side view

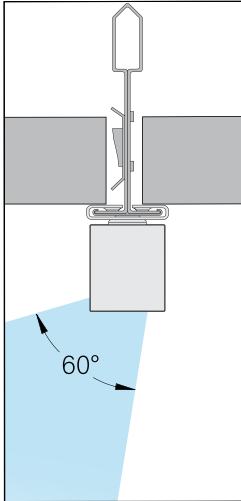

### LIGHT DISTRIBUTION

Velino.0 Lay-In 9/16" T-Grid Clip-On - Surface Mount

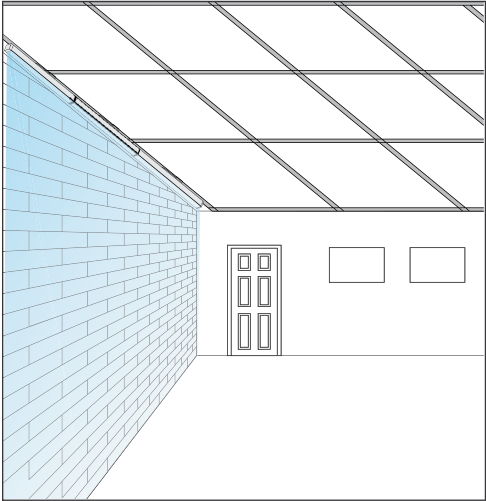

Light spread representation

## Velino.0 T-Grid Clip-On

Lay-In 9/16" T-Grid Clip-On Asymmetrical - Dark Optics - Surface-Mount

Specification Submittal

### ◆ Photometry

DA = Dark Optic Asymmetric - (Asymmetric beam for wall-washing), L10 - 3500K

#### LUMEN SUMMARY

Zone	Lumens	% Fixture
75° - 90°	1.43 lm	0.19%
60° - 75°	27.6 lm	3.66%
45° - 60°	130 lm	17.24%
30° - 45°	261 lm	34.62%
15° - 30°	243 lm	32.23%
0° - 15°	87.8 lm	11.64%

#### ANGULAR DISTRIBUTION

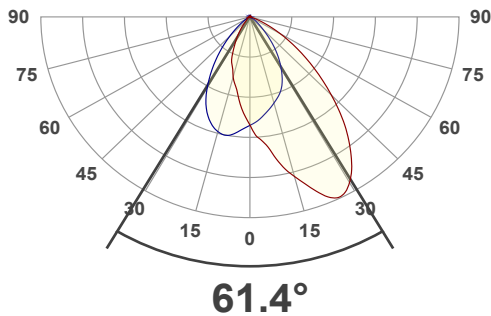

#### COLOR VECTOR GRAPHIC

		Graphic shifts (%)	
Hue Bin	R <sub>f</sub>	Chroma	Hue
1	95	-1%	0%
2	96	1%	-1%
3	94	0%	-1%
4	94	-2%	-3%
5	93	-5%	0%
6	95	1%	3%
7	93	0%	4%
8	94	3%	3%
9	94	2%	3%
10	94	2%	4%
11	92	4%	3%
12	88	6%	-5%
13	89	1%	-9%
14	90	2%	-7%
15	90	0%	-3%
16	90	1%	-5%

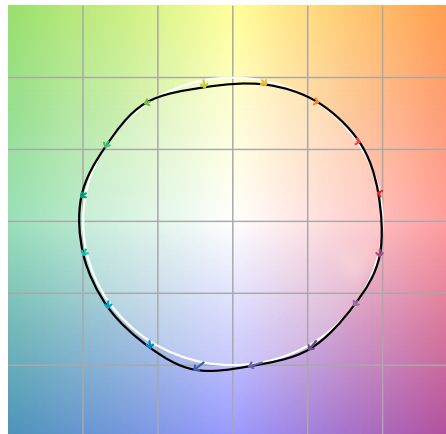

□ Reference    ■ Test